

Tool sharpening



Flaring and cylindrical cup wheels

Peripheral speed 35 m/sec



SHAPES AND DIMENSIONS					
Shape	D	T	H	W	E
T6	80	40	20	10	10
	100	50	20 - 32	10	10
	125	50	32	10	10
	150	50	32	10	16
	150	63	32	16	16
	200	40	76,2	40	13

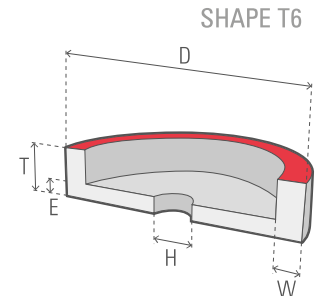

SHAPES AND DIMENSIONS							
Shape	D	T	H	W	E	J	K
T11	80	32	20	8	10	57	46
	100	40	20 - 32	8	10	75	65
	125	45	32	8	10	96	78
	150	50	32	10	13	114	95

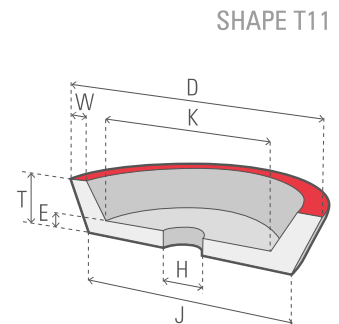

SPECIFICATIONS				
Material	Type	Specification	Use	Remarks
Steel	HSS Alloy steels	09A046K06V86	Roughing General use	
		09A060K06V86	Finishing General use	
		3HA060K07V114	General use Cool grinding without deformation	
		11A080K06V92	General use	Only for wheels T6 - D100
		31A070J07V86	General use	Only for wheels T6 - D100
Hard metal	Tungsten carbide tools	08C060J08V01	Roughing	
		08C080J08V01	Finishing	

EXAMPLE OF ORDER

SHAPE	DIMENSIONS (mm)	NOTE	SPEED	SPECIFICATION	
T6	100 x 50 x 20	W=10 E=10	35 m/sec	31A070J07V86	• The coloured dot shows the actual colour of the wheel



Tapered and dish wheels for dry application

Peripheral speed 35 m/sec

SHAPES AND DIMENSIONS					
Shape	D	T	H	U	J
T3	125	8	20 - 32	2	63
	150	8	20 - 32	2	75

SHAPES AND DIMENSIONS							
Shape	D	T	H	W	U	E	J=K
T12	80	10	13	4	2	6	31
	100	13	20	5	3	7	36
	125	14	20 - 32	6	3	7	61
	150	16	20 - 32	8	3	9	66
	200	19	32	10	3	12	90
	200	32	32	10	3	12	90

SPECIFICATIONS			
Material	Type	Specification	application
Steel	HSS and alloy steels	09A046K06V86	● General use
		3HA060K07V114	● General use
Hard metal	Carbide Tungsten carbide tools	08C060J08V01	● General use

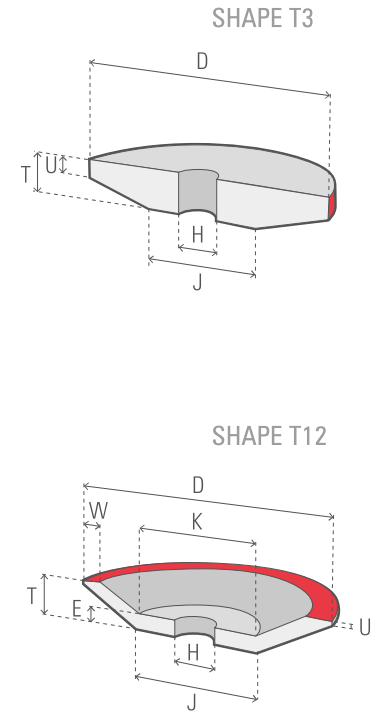

Grinding wheels for circular saw sharpening

Speed 35 and 60 m/sec



SHAPES AND DIMENSIONS			
Shape	D	T	H
T1	150	1,0 - 1,5 - 2 - 2,5 - 3 - 3,5 - 4 - 4,5 - 5 - 6	32
	175	2 - 3 - 4 - 6 - 8	51
	200	1,0 - 1,5 - 2 - 2,5 - 3 - 3,5 - 4 - 4,5 - 5 - 6 - 8 - 10	32
	250	6 - 8 - 10 - 13	32

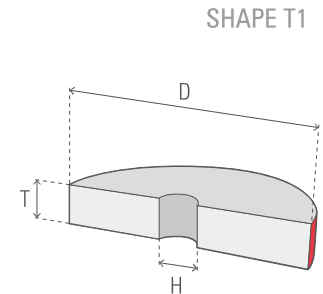

SPECIFICATIONS			
Material	Type	Specification	application
Circular saws	HSS and Stellite	11A080N05V86	For very narrow toothed saws wheel thickness $\leq 3,5$ mm
		11A080M06V86	For medium toothed saws wheel thickness 4 ÷ 5mm
		11A054M06V86	For wide narrow toothed saws wheel thickness ≥ 6 mm
		09A080K08V20	General use high-speed grinding wheels

Grinding wheels for band saw sharpening

Peripheral speed 35 m/sec

SHAPES AND DIMENSIONS			
Shape	D	T	H
T1	150	6 - 8 - 10	20 - 32
	200	6 - 8 - 10 - 13	32
	225	8 - 10 - 13	32
	250	8 - 10 - 13	32
	300	16 - 20	32

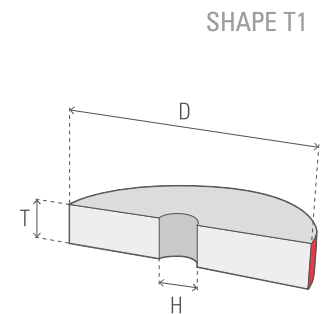

T1-BD = SHAPE T1 WITH RESIN HARD SIDE

SPECIFICATIONS			
Material	Type	Specification	application
Band saws	High alloy steels HSS and Stellite	09A054M06V86	General use
		09A054L06V86 1 resin hardened edge	General use improved profile*
		11A054M06V86	General use good profile retention
		11A054L06V86 1 resin hardened edge	General use improved profile retention*

* Best for stellite saws



Profiled wheels for conventional band saw sharpening

Peripheral speed 35 m/sec

SHAPES AND DIMENSIONS			
Shape	D	T	H
T1-PR Profile C - 45°	150	6 - 8	20 - 32
	200	6 - 8- 10	20 - 32
	250	10 - 13	32

SPECIFICATIONS			
Material	Type	Specification	application
Conventional band saws	Medium-low hardness steel	15A060N05V12	● General use
		09A054M06V86	○ General use Best removal
	High alloy steels HSS and Stellite	5SA080007 BGW	● For automatic machines type Vollmer and Iseli

SHAPE T1 PROFILE C - 45°

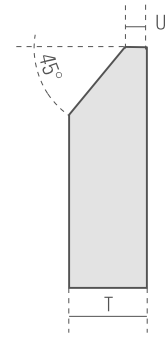

Thin wheels for circular saw sharpening

Speed 50 m/sec

SHAPES AND DIMENSIONS			
Shape	D	T	H
T1-PR	120	2	51
	150	1,5 - 2 - 3	20 - 32
	175	2 - 3	51
	200	1,5 - 2 - 3 - 4	32

SPECIFICATIONS			
Material	Type	Abrasive	application
Circular saws with narrow teeth	Hardened steel - HSS	17A060P05BA	● General use
		09A054M06V86	○ General use quick removal

SHAPE T1

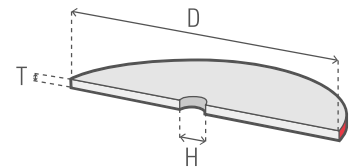

EXAMPLE OF ORDER

SHAPE	DIMENSIONS (mm)	NOTE	SPEED	SPECIFICATION	
T1 - PR	150 x 6 x 20	profile C-45°	35 m/sec	15A060N05V12	● The coloured dot shows the actual colour of the wheel