



RISCALDATORE ULTRAMAX (CON TERMOCOPPIA O SENZA TERMOCOPPIA)

ULTRAMAX HEATER (WITH OR WITHOUT THERMOCOUPLE)

ERHITZER ULTRAMAX (MIT ODER OHNE THERMOELEMENT)

EUTX

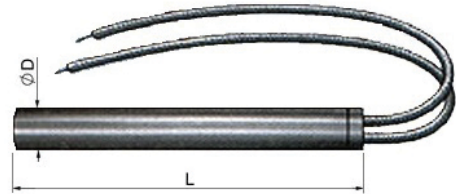

Ø 6,5 (-0,03 / -0,05)			Ø 8 (-0,04 / -0,06)			Ø 10 (-0,04 / -0,07)			Ø 12,5 (-0,05 / -0,08)			
L	W/230 V	W/CM ³	L	W/230 V	W/CM ³	L	W/230 V	W/CM ³	L	W/230 V	W/CM ³	
40	125	22	40	150	21	40	150	18	40	200	20	
	150	27		200	28		200	24		250	25	
	175	31	50	150	16	50	250	30	50	300	22	
	200	36		200	22		200	18		400	29	
50	150	20	60	250	27	60	250	22	60	300	17	
	175	24		200	17		300	26		400	23	
	200	27	80	250	21	80	250	18	80	400	16	
	250	34		300	25		300	21		500	20	
60	200	21	100	200	12	100	400	28	100	500	15	
	250	26		250	15		80	250		12	130	600
	300	32	130	300	18	130	300	15	130	160	800	13
	400	40		400	24		400	20		200	1000	14
80	200	15	160	200	9	160	300	11	160	250	1250	14
	250	19		250	12		400	15		300	1500	14
	300	22	130	300	14	130	500	19	130	300	1500	14
	400	23		400	19		130	300		8	400	11
100	250	15	160	250	9	160	400	11	160	500	14	
	300	17		300	10		400	14		600	13	
	400	23	160	400	14	160	600	13	160	400	9	
				500	14		400	11		500	14	

Esempio di ordinativo: DxLxW

Order example: DxLxW

Bestellbeispiel: DxLxW

RISCALDATORE ULTRAMAX (CON TERMOCOPPIA O SENZA TERMOCOPPIA)

ULTRAMAX HEATER (WITH OR WITHOUT THERMOCOUPLE)

ERHITZER ULTRAMAX (MIT ODER OHNE THERMOELEMENT)

EUTX

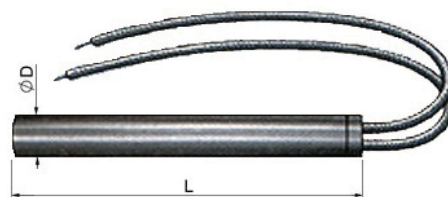

Ø 1/4" 6,35MM (-0,03 / -0,05)			Ø 3/8" 9,52MM (-0,04 / -0,07)			Ø 1/2" 12,7MM (-0,05 / -0,08)			
L	W/230 V	W/CM ³	L	W/230 V	W/CM ³	L	W/230 V	W/CM ³	
1 1/2" 38,1mm	125	24	1 1/2" 38,1mm	150	17	1 1/2"	200	22	
	150	29		200	22		250	27	
	175	34		250	28		250	20	
	200	38		300	33		300	25	
2" 50,8mm	150	20	1 3/4" 44,4mm	150	17	2"	300	20	
	175	23		200	22		400	26	
	200	26		250	28		2 1/2"	300	16
	250	33		300	33		400	21	
2 1/2" 63,5mm	200	20	2" 50,8mm	200	18	3"	400	17	
	250	25		250	22		500	21	
	300	30		300	27		3 1/2"	500	17
3" 76,2mm	200	16	2 1/2" 63,5mm	250	17	4"	500	15	
	250	20		300	20		5"	600	14
	300	24		350	23		6"	750	14
3 1/2" 88,9mm	250	16	3" 76,2mm	250	14	7"	1000	15	
	300	20		300	16		8"	1000	13
4" 101mm	250	14		350	19	9"	1200	14	
	300	17		400	22		10"	1200	13
	400	23	3 1/2" 88,9mm	300	14	12"	1500	13	
				400	18				
				500	22				
			4" 101mm	300	12				
				400	15				
				500	19				
			5" 127mm	400	12				
				500	15				
			6" 152,4mm	400	10				
				500	12				
				600	15				

Esempio di ordinativo: DxLxW

Order example: DxLxW

Bestellbeispiel: DxLxW

RESISTENZA A FASCIA PER UGELLO
STRIP HEATER FOR NOZZLE
 HEIZELEMENT FÜR ANGUSSBUCHSE

ERU

TIPO A - TYPE A - TYP A

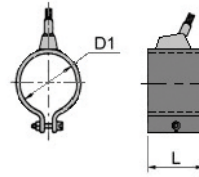

TIPO B - TYPE B - TYP B

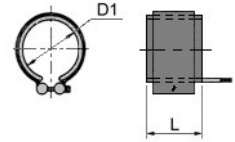

D1	L	WATT
25	30	90
30	25	90
	30	110
	35	130
	40	150
35	25	110
	30	130
	35	150
	40	170
40	45	190
	25	125
	30	150
	35	175
42	40	220
	45	225
	25	130
	30	160
45	35	180
	40	210
	25	140
	30	170
	35	200
45	40	230
	45	250
	50	280
	55	310

D1	L	WATT	
50	20	120	
	25	150	
	30	190	
	35	220	
50	40	250	
	50	310	
	60	380	
	55	20	140
25		170	
30		210	
35		240	
55	40	280	
	50	350	
	60	20	150
		25	190
30		220	
35		260	
40		300	
60	50	380	
	60	450	

Esempio di ordinativo: Tipo x D1 x L **Order example:** Type x D1 x L **Bestellbeispiel:** Typ x D1 x L

TERMOCOPPIA
THERMOCOUPLE
THERMOELEMENT

ET-1

Standard: 2000 mm cavi - Rosso (+) Blu (-)
Standard: 2000 mm cables - Red (+) Blue (-)
Standard: 2000 mm Kabel - Rot (+) Blau (-)

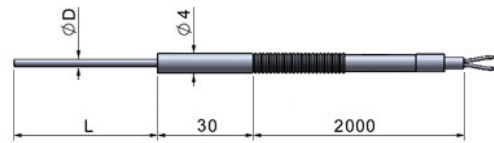

D	L
1,5	100
1,5	200

Esempio di ordinativo: DxL **Order example:** DxL **Bestellbeispiel:** DxL

Altre lunghezze disponibili a richiesta - Other lengths supplied on request - Andere Längen auf Anfrage verfügbar

TERMOCOPPIA
THERMOCOUPLE
THERMOELEMENT

ET-2

Standard: 2000 mm cavi - Rosso (+) Blu (-)
Standard: 2000 mm cables - Red (+) Blue (-)
Standard: 2000 mm Kabel - Rot (+) Blau (-)

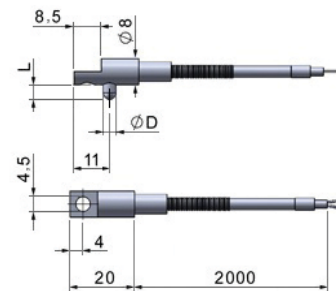

D	L
4,0	20,0

Esempio di ordinativo: D1xL **Order example:** D1xL **Bestellbeispiel:** D1xL

Altre lunghezze disponibili a richiesta - Other lengths supplied on request - Andere Längen auf Anfrage verfügbar

TERMOCOPPIA AD ASOLA
THERMOCOUPLE WITH HOLE
THERMOELEMENT MIT LOCH

ET-3

Standard: 1000 mm cavi - Rosso (+) Blu (-)
Standard: 1000 mm cables - Red (+) Blue (-)
Standard: 1000 mm Kabel - Rot (+) Blau (-)

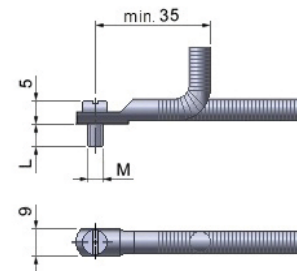

M	L
5	5

Esempio di ordinativo: MxL **Order example:** MxL **Bestellbeispiel:** MxL

Altre lunghezze disponibili a richiesta - Other lengths supplied on request - Andere Längen auf Anfrage verfügbar

TERMOCOPPIA A LAMINA
THERMOCOUPLE WITH FLAT END
 FLACHES THERMOELEMENT

ET-4

- Standard:** 1000 mm cavi - Rosso (+) Blu (-)
- Standard:** 1000 mm cables - Red (+) Blue (-)
- Standard:** 1000 mm Kabel - Rot (+) Blau (-)

D	L
4,0	13

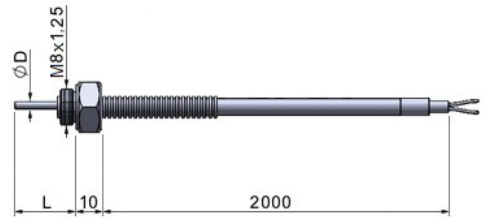

Esempio di ordinativo: DxL **Order example:** DxL **Bestellbeispiel:** DxL

Altre lunghezze disponibili a richiesta - Other lengths supplied on request - Andere Längen auf Anfrage verfügbar

TERMOCOPPIA
THERMOCOUPLE
 THERMOELEMENT

ET-6

- Standard:** 2000 mm cavi - Rosso (+) Blu (-)
- Standard:** 2000 mm cables - Red (+) Blue (-)
- Standard:** 2000 mm Kabel - Rot (+) Blau (-)

D	L
6	15
6	35

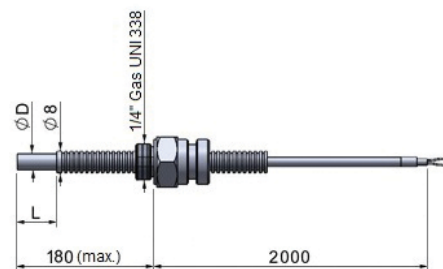

Esempio di ordinativo: D1xL **Order example:** D1xL **Bestellbeispiel:** D1xL

Altre lunghezze disponibili a richiesta - Other lengths supplied on request - Andere Längen auf Anfrage verfügbar

TERMOCOPPIA
THERMOCOUPLE
 THERMOELEMENT

ET-8

- Standard:** 2000 mm cavi - Rosso (+) Blu (-)
- Standard:** 2000 mm cables - Red (+) Blue (-)
- Standard:** 2000 mm Kabel - Rot (+) Blau (-)

D	L
8	15
8	35

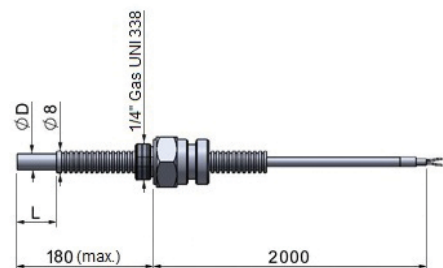

Esempio di ordinativo: D1xL **Order example:** D1xL **Bestellbeispiel:** D1xL

Altre lunghezze disponibili a richiesta - Other lengths supplied on request - Andere Längen auf Anfrage verfügbar