

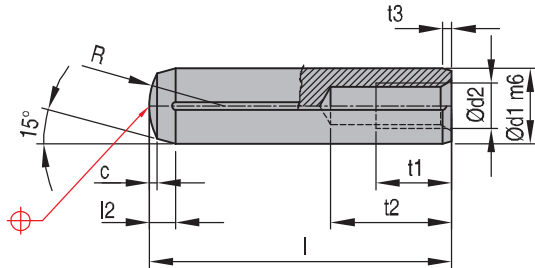

Dowel pins with internal thread as per DIN EN 28735 - Type A Mat.: Gehard: 650 - 750 HV 30

WZ 7005



REF	d1	L	c	d2	l2	R	t1	t2	t3
WZ 7005	6	20	0,6	M4	1,5	6	6	10	1,0
WZ 7005	6	24	0,6	M4	1,5	6	6	10	1,0
WZ 7005	6	28	0,6	M4	1,5	6	6	10	1,0
WZ 7005	6	32	0,6	M4	1,5	6	6	10	1,0
WZ 7005	6	36	0,6	M4	1,5	6	6	10	1,0
WZ 7005	6	40	0,6	M4	1,5	6	6	10	1,0
WZ 7005	6	45	0,6	M4	1,5	6	6	10	1,0
WZ 7005	6	50	0,6	M4	1,5	6	6	10	1,0
WZ 7005	6	60	0,6	M4	1,5	6	6	10	1,0
WZ 7005	8	20	0,8	M5	1,8	8	8	13	1,2
WZ 7005	8	24	0,8	M5	1,8	8	8	13	1,2
WZ 7005	8	28	0,8	M5	1,8	8	8	13	1,2
WZ 7005	8	32	0,8	M5	1,8	8	8	13	1,2
WZ 7005	8	36	0,8	M5	1,8	8	8	13	1,2
WZ 7005	8	40	0,8	M5	1,8	8	8	13	1,2
WZ 7005	8	45	0,8	M5	1,8	8	8	13	1,2
WZ 7005	8	50	0,8	M5	1,8	8	8	13	1,2
WZ 7005	8	60	0,8	M5	1,8	8	8	13	1,2
WZ 7005	8	80	0,8	M5	1,8	8	8	13	1,2

REF	d1	L	c	d2	l2	R	t1	t2	t3
WZ 7005	10	24	1,0	M6	2,0	10	10	16	1,2
WZ 7005	10	28	1,0	M6	2,0	10	10	16	1,2
WZ 7005	10	32	1,0	M6	2,0	10	10	16	1,2
WZ 7005	10	36	1,0	M6	2,0	10	10	16	1,2
WZ 7005	10	40	1,0	M6	2,0	10	10	16	1,2
WZ 7005	10	45	1,0	M6	2,0	10	10	16	1,2
WZ 7005	10	50	1,0	M6	2,0	10	10	16	1,2
WZ 7005	10	60	1,0	M6	2,0	10	10	16	1,2
WZ 7005	10	70	1,0	M6	2,0	10	10	16	1,2
WZ 7005	10	80	1,0	M6	2,0	10	10	16	1,2
WZ 7005	10	100	1,0	M6	2,0	10	10	16	1,2
WZ 7005	12	32	1,3	M6	2,5	12	12	18	1,2
WZ 7005	12	36	1,3	M6	2,5	12	12	18	1,2
WZ 7005	12	40	1,3	M6	2,5	12	12	18	1,2
WZ 7005	12	45	1,3	M6	2,5	12	12	18	1,2
WZ 7005	12	50	1,3	M6	2,5	12	12	18	1,2
WZ 7005	12	60	1,3	M6	2,5	12	12	18	1,2
WZ 7005	12	70	1,3	M6	2,5	12	12	18	1,2
WZ 7005	12	80	1,3	M6	2,5	12	12	18	1,2
WZ 7005	12	90	1,3	M6	2,5	12	12	18	1,2
WZ 7005	12	100	1,3	M6	2,5	12	12	18	1,2

REF	d1	L	c	d2	l2	R	t1	t2	t3
WZ 7005	14	32	1,3	M8	2,5	12	16	18	1,2
WZ 7005	14	36	1,3	M8	2,5	12	16	18	1,2
WZ 7005	14	40	1,3	M8	2,5	12	16	18	1,2
WZ 7005	14	45	1,3	M8	2,5	12	16	18	1,2
WZ 7005	14	50	1,3	M8	2,5	12	16	18	1,2
WZ 7005	14	60	1,3	M8	2,5	12	16	18	1,2
WZ 7005	14	80	1,3	M8	2,5	12	16	18	1,2
WZ 7005	14	100	1,3	M8	2,5	12	16	18	1,2
WZ 7005	16	40	1,7	M8	3,0	16	16	23	1,6
WZ 7005	16	45	1,7	M8	3,0	16	16	23	1,6
WZ 7005	16	50	1,7	M8	3,0	16	16	23	1,6
WZ 7005	16	60	1,7	M8	3,0	16	16	23	1,6
WZ 7005	16	80	1,7	M8	3,0	16	16	23	1,6
WZ 7005	16	100	1,7	M8	3,0	16	16	23	1,6
WZ 7005	20	50	2,0	M10	4,0	20	20	27	1,6
WZ 7005	20	60	2,0	M10	4,0	20	20	27	1,6
WZ 7005	20	80	2,0	M10	4,0	20	20	27	1,6
WZ 7005	20	100	2,0	M10	4,0	20	20	27	1,6



DP

Dowel pins

Mat.: DIN 6325 ISO 8734 ±60 HRC

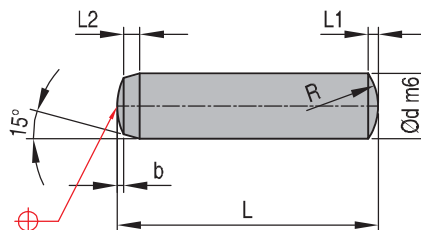

REF	L2	L1	b	R
DP 1,5-6	0,5	0,23	0,12	1,6
DP 1,5-8	0,5	0,23	0,12	1,6
DP 1,5-10	0,5	0,23	0,12	1,6
DP 1,5-12	0,5	0,23	0,12	1,6
DP 1,5-14	0,5	0,23	0,12	1,6
DP 1,5-16	0,5	0,23	0,12	1,6
DP 1,5-20	0,5	0,23	0,12	1,6
DP 2-6	0,6	0,30	0,18	2,0
DP 2-8	0,6	0,30	0,18	2,0
DP 2-10	0,6	0,30	0,18	2,0
DP 2-12	0,6	0,30	0,18	2,0
DP 2-14	0,6	0,30	0,18	2,0
DP 2-16	0,6	0,30	0,18	2,0
DP 2-18	0,6	0,30	0,18	2,0
DP 2-20	0,6	0,30	0,18	2,0
DP 2,5-6	0,7	0,40	0,25	2,5
DP 2,5-8	0,7	0,40	0,25	2,5
DP 2,5-10	0,7	0,40	0,25	2,5
DP 2,5-12	0,7	0,40	0,25	2,5
DP 2,5-14	0,7	0,40	0,25	2,5
DP 2,5-16	0,7	0,40	0,25	2,5
DP 2,5-18	0,7	0,40	0,25	2,5
DP 2,5-20	0,7	0,40	0,25	2,5
DP 2,5-24	0,7	0,40	0,25	2,5
DP 3-8	0,8	0,45	0,30	3,0
DP 3-10	0,8	0,45	0,30	3,0
DP 3-12	0,8	0,45	0,30	3,0
DP 3-14	0,8	0,45	0,30	3,0
DP 3-16	0,8	0,45	0,30	3,0
DP 3-18	0,8	0,45	0,30	3,0
DP 3-20	0,8	0,45	0,30	3,0
DP 3-24	0,8	0,45	0,30	3,0
DP 3-28	0,8	0,45	0,30	3,0
DP 3-32	0,8	0,45	0,30	3,0
DP 3-50	0,8	0,45	0,30	3,0
DP 4-10	1,0	0,60	0,40	4,0
DP 4-12	1,0	0,60	0,40	4,0
DP 4-14	1,0	0,60	0,40	4,0
DP 4-16	1,0	0,60	0,40	4,0
DP 4-18	1,0	0,60	0,40	4,0
DP 4-20	1,0	0,60	0,40	4,0
DP 4-24	1,0	0,60	0,40	4,0
DP 4-28	1,0	0,60	0,40	4,0
DP 4-30	1,0	0,60	0,40	4,0
DP 4-32	1,0	0,60	0,40	4,0
DP 4-36	1,0	0,60	0,40	4,0
DP 4-40	1,0	0,60	0,40	4,0
DP 4-45	1,0	0,60	0,40	4,0
DP 4-50	1,0	0,60	0,40	4,0

REF	L2	L1	b	R
DP 5-8	1,2	0,75	0,50	5,0
DP 5-10	1,2	0,75	0,50	5,0
DP 5-12	1,2	0,75	0,50	5,0
DP 5-14	1,2	0,75	0,50	5,0
DP 5-16	1,2	0,75	0,50	5,0
DP 5-18	1,2	0,75	0,50	5,0
DP 5-20	1,2	0,75	0,50	5,0
DP 5-24	1,2	0,75	0,50	5,0
DP 5-28	1,2	0,75	0,50	5,0
DP 5-32	1,2	0,75	0,50	5,0
DP 5-36	1,2	0,75	0,50	5,0
DP 5-40	1,2	0,75	0,50	5,0
DP 5-45	1,2	0,75	0,50	5,0
DP 5-50	1,2	0,75	0,50	5,0
DP 6-10	1,5	0,90	0,60	6,0
DP 6-14	1,5	0,90	0,60	6,0
DP 6-16	1,5	0,90	0,60	6,0
DP 6-18	1,5	0,90	0,60	6,0
DP 6-20	1,5	0,90	0,60	6,0
DP 6-24	1,5	0,90	0,60	6,0
DP 6-28	1,5	0,90	0,60	6,0
DP 6-32	1,5	0,90	0,60	6,0
DP 6-36	1,5	0,90	0,60	6,0
DP 6-40	1,5	0,90	0,60	6,0
DP 6-45	1,5	0,90	0,60	6,0
DP 6-50	1,5	0,90	0,60	6,0
DP 6-55	1,5	0,90	0,60	6,0
DP 6-60	1,5	0,90	0,60	6,0
DP 8-18	1,8	1,20	0,80	8,0
DP 8-20	1,8	1,20	0,80	8,0
DP 8-24	1,8	1,20	0,80	8,0
DP 8-28	1,8	1,20	0,80	8,0
DP 8-32	1,8	1,20	0,80	8,0
DP 8-36	1,8	1,20	0,80	8,0
DP 8-40	1,8	1,20	0,80	8,0
DP 8-45	1,8	1,20	0,80	8,0
DP 8-50	1,8	1,20	0,80	8,0
DP 8-55	1,8	1,20	0,80	8,0
DP 8-60	1,8	1,20	0,80	8,0
DP 8-70	1,8	1,20	0,80	8,0
DP 8-80	1,8	1,20	0,80	8,0
DP 8-100	1,8	1,20	0,80	8,0

REF	L2	L1	b	R
DP 10-16	2,0	1,50	1,00	10,0
DP 10-24	2,0	1,50	1,00	10,0
DP 10-28	2,0	1,50	1,00	10,0
DP 10-30	2,0	1,50	1,00	10,0
DP 10-32	2,0	1,50	1,00	10,0
DP 10-36	2,0	1,50	1,00	10,0
DP 10-40	2,0	1,50	1,00	10,0
DP 10-45	2,0	1,50	1,00	10,0
DP 10-50	2,0	1,50	1,00	10,0
DP 10-55	2,0	1,50	1,00	10,0
DP 10-60	2,0	1,50	1,00	10,0
DP 10-70	2,0	1,50	1,00	10,0
DP 10-80	2,0	1,50	1,00	10,0
DP 10-90	2,0	1,50	1,00	10,0
DP 10-100	2,0	1,50	1,00	10,0
DP 12-28	2,5	1,80	1,30	12,0
DP 12-32	2,5	1,80	1,30	12,0
DP 12-36	2,5	1,80	1,30	12,0
DP 12-40	2,5	1,80	1,30	12,0
DP 12-45	2,5	1,80	1,30	12,0
DP 12-50	2,5	1,80	1,30	12,0
DP 12-55	2,5	1,80	1,30	12,0
DP 12-60	2,5	1,80	1,30	12,0
DP 12-70	2,5	1,80	1,30	12,0
DP 12-80	2,5	1,80	1,30	12,0
DP 12-90	2,5	1,80	1,30	12,0
DP 12-100	2,5	1,80	1,30	12,0
DP 14-40	2,5	2,00	1,30	14,0
DP 14-45	2,5	2,00	1,30	14,0
DP 14-50	2,5	2,00	1,30	14,0
DP 14-60	2,5	2,00	1,30	14,0
DP 14-70	2,5	2,00	1,30	14,0
DP 14-80	2,5	2,00	1,30	14,0
DP 14-90	2,5	2,00	1,30	14,0
DP 14-100	2,5	2,00	1,30	14,0
DP 14-120	2,5	2,00	1,30	14,0
DP 16-50	3,0	2,50	1,70	16,0
DP 16-60	3,0	2,50	1,70	16,0
DP 16-70	3,0	2,50	1,70	16,0
DP 16-80	3,0	2,50	1,70	16,0
DP 16-100	3,0	2,50	1,70	16,0
DP 16-120	3,0	2,50	1,70	16,0
DP 16-140	3,0	2,50	1,70	16,0
DP 20-60	4,0	3,00	2,00	20,0
DP 20-80	4,0	3,00	2,00	20,0
DP 20-100	4,0	3,00	2,00	20,0
DP 20-120	4,0	3,00	2,00	20,0

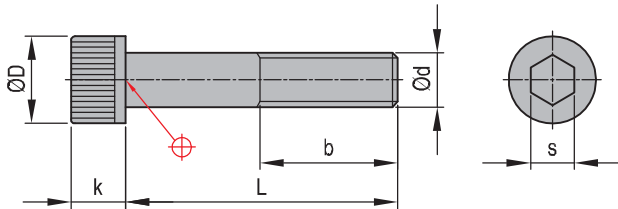
Socket head cap screws DIN 912 - 12,9
M

REF d x L	d	b	D	k	s
M3 x 10	M3	10	5,5	3	2,5
M4 x 8	M4	12	7	4	3
M4 x 10	M4	12	7	4	3
M4 x 20	M4	12	7	4	3
M4 x 30	M4	12	7	4	3
M5 x 10	M5	15	9	5	4
M5 x 16	M5	15	9	5	4
M5 x 20	M5	15	9	5	4
M5 x 25	M5	15	9	5	4
M5 x 35	M5	15	9	5	4
M6 x 8	M6	18	10	6	5
M6 x 10	M6	18	10	6	5
M6 x 12	M6	18	10	6	5
M6 x 14	M6	18	10	6	5
M6 x 16	M6	18	10	6	5
M6 x 18	M6	18	10	6	5
M6 x 20	M6	18	10	6	5
M6 x 22	M6	18	10	6	5
M6 x 25	M6	18	10	6	5
M6 x 30	M6	18	10	6	5
M6 x 35	M6	18	10	6	5
M6 x 40	M6	18	10	6	5
M6 x 45	M6	18	10	6	5
M6 x 50	M6	18	10	6	5
M6 x 55	M6	18	10	6	5
M6 x 60	M6	18	10	6	5
M6 x 65	M6	18	10	6	5
M6 x 70	M6	18	10	6	5
M6 x 75	M6	18	10	6	5
M6 x 80	M6	18	10	6	5
M6 x 90	M6	18	10	6	5
M6 x 100	M6	18	10	6	5
M6 x 110	M6	18	10	6	5
M6 x 120	M6	18	10	6	5
M6 x 160	M6	18	10	6	5
M8 x 10	M8	22	13	8	6
M8 x 12	M8	22	14	8	6
M8 x 16	M8	22	15	8	6
M8 x 18	M8	22	16	8	6
M8 x 20	M8	22	17	8	6
M8 x 22	M8	22	18	8	6
M8 x 25	M8	22	19	8	6
M8 x 30	M8	22	20	8	6
M8 x 35	M8	22	21	8	6
M8 x 40	M8	22	22	8	6
M8 x 45	M8	22	23	8	6
M8 x 50	M8	22	24	8	6
M8 x 55	M8	22	25	8	6
M8 x 60	M8	22	26	8	6
M8 x 65	M8	22	27	8	6
M8 x 70	M8	22	28	8	6

REF d x L	d	b	D	k	s
M8 x 75	M8	22	29	8	6
M8 x 80	M8	22	30	8	6
M8 x 90	M8	22	31	8	6
M8 x 100	M8	22	32	8	6
M8 x 110	M8	22	33	8	6
M8 x 120	M8	22	34	8	6
M8 x 130	M8	22	35	8	6
M8 x 140	M8	22	36	8	6
M8 x 150	M8	22	37	8	6
M8 x 160	M8	22	38	8	6
M8 x 180	M8	22	39	8	6
M10 x 12	M10	25	16	10	8
M10 x 16	M10	25	16	10	8
M10 x 20	M10	25	16	10	8
M10 x 22	M10	25	16	10	8
M10 x 25	M10	25	16	10	8
M10 x 30	M10	25	16	10	8
M10 x 35	M10	25	16	10	8
M10 x 40	M10	25	16	10	8
M10 x 45	M10	25	16	10	8
M10 x 50	M10	25	16	10	8
M10 x 55	M10	25	16	10	8
M10 x 60	M10	25	16	10	8
M10 x 65	M10	25	16	10	8
M10 x 70	M10	25	16	10	8
M10 x 75	M10	25	16	10	8
M10 x 80	M10	25	16	10	8
M10 x 90	M10	25	16	10	8
M10 x 100	M10	25	16	10	8
M10 x 110	M10	25	16	10	8
M10 x 120	M10	25	16	10	8
M10 x 130	M10	25	16	10	8
M10 x 140	M10	25	16	10	8
M10 x 150	M10	25	16	10	8
M10 x 160	M10	25	16	10	8
M10 x 170	M10	25	16	10	8
M10 x 180	M10	25	16	10	8
M10 x 200	M10	25	16	10	8
M10 x 260	M10	25	16	10	8
M10 x 280	M10	25	16	10	8
M12 x 20	M12	28	18	12	10
M12 x 25	M12	28	18	12	10
M12 x 30	M12	28	18	12	10
M12 x 35	M12	28	18	12	10
M12 x 40	M12	28	18	12	10
M12 x 45	M12	28	18	12	10
M12 x 50	M12	28	18	12	10
M12 x 55	M12	28	18	12	10
M12 x 60	M12	28	18	12	10
M12 x 65	M12	28	18	12	10
M12 x 70	M12	28	18	12	10

REF d x L	d	b	D	k	s
M12 x 75	M12	28	18	12	10
M12 x 80	M12	28	18	12	10
M12 x 90	M12	28	18	12	10
M12 x 100	M12	28	18	12	10
M12 x 110	M12	28	18	12	10
M12 x 120	M12	28	18	12	10
M12 x 130	M12	28	18	12	10
M12 x 140	M12	28	18	12	10
M12 x 150	M12	28	18	12	10
M12 x 160	M12	28	18	12	10
M12 x 170	M12	28	18	12	10
M12 x 180	M12	28	18	12	10
M12 x 190	M12	28	18	12	10
M12 x 200	M12	28	18	12	10
M12 x 220	M12	28	18	12	10
M12 x 260	M12	28	18	12	10
M16 x 30	M16	38	24	16	14
M16 x 35	M16	38	24	16	14
M16 x 40	M16	38	24	16	14
M16 x 45	M16	38	24	16	14
M16 x 50	M16	38	24	16	14
M16 x 60	M16	38	24	16	14
M16 x 65	M16	38	24	16	14
M16 x 70	M16	38	24	16	14
M16 x 80	M16	38	24	16	14
M16 x 100	M16	38	24	16	14
M16 x 120	M16	38	24	16	14
M16 x 130	M16	44	24	16	14
M16 x 140	M16	44	24	16	14
M16 x 150	M16	44	24	16	14
M16 x 160	M16	44	24	16	14
M16 x 180	M16	44	24	16	14
M16 x 190	M16	44	24	16	14
M16 x 200	M16	57	24	16	14
M16 x 210	M16	57	24	16	14
M16 x 220	M16	57	24	16	14
M16 x 240	M16	57	24	16	14
M16 x 260	M16	57	24	16	14
M16 x 300	M16	57	24	16	14
M20 x 60	M20	52	30	20	17
M20 x 120	M20	52	30	20	17
M20 x 140	M20	52	30	20	17
M20 x 150	M20	52	30	20	17
M20 x 160	M20	52	30	20	17
M20 x 180	M20	52	30	20	17
M20 x 200	M20	65	30	20	17
M20 x 210	M20	65	30	20	17
M20 x 240	M20	65	30	20	17
M20 x 260	M20	65	30	20	17
M20 x 300	M20	-	30	20	17



IS 610

Socket head cap screws DIN 912 - 10,9

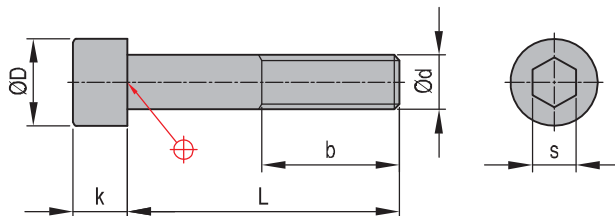

REF d x L	d	D	k	s
IS 610- M3x12	M3	5,5	3	2,5
IS 610- M3x16	M3	5,5	3	2,5
IS 610- M3x20	M3	5,5	3	2,5
IS 610- M3x25	M3	5,5	3	2,5
IS 610- M4x6	M4	7	4	3
IS 610- M4x8	M4	7	4	3
IS 610- M4x10	M4	7	4	3
IS 610- M4x12	M4	7	4	3
IS 610- M4x14	M4	7	4	3
IS 610- M4x16	M4	7	4	3
IS 610- M4x18	M4	7	4	3
IS 610- M4x20	M4	7	4	3
IS 610- M4x22	M4	7	4	3
IS 610- M4x25	M4	7	4	3
IS 610- M4x30	M4	7	4	3
IS 610- M4x35	M4	7	4	3
IS 610- M4x40	M4	7	4	3
IS 610- M5x10	M5	8,5	5	4
IS 610- M5x12	M5	8,5	5	4
IS 610- M5x14	M5	8,5	5	4
IS 610- M5x16	M5	8,5	5	4
IS 610- M5x20	M5	8,5	5	4
IS 610- M5x22	M5	8,5	5	4
IS 610- M5x25	M5	8,5	5	4
IS 610- M5x30	M5	8,5	5	4
IS 610- M5x35	M5	8,5	5	4
IS 610- M5x40	M5	8,5	5	4
IS 610- M5x45	M5	8,5	5	4
IS 610- M5x50	M5	8,5	5	4
IS 610- M5x55	M5	8,5	5	4
IS 610- M5x60	M5	8,5	5	4
IS 610- M6x8	M6	10	6	5
IS 610- M6x10	M6	10	6	5
IS 610- M6x12	M6	10	6	5
IS 610- M6x14	M6	10	6	5
IS 610- M6x16	M6	10	6	5
IS 610- M6x18	M6	10	6	5
IS 610- M6x20	M6	10	6	5
IS 610- M6x22	M6	10	6	5
IS 610- M6x25	M6	10	6	5
IS 610- M6x30	M6	10	6	5
IS 610- M6x35	M6	10	6	5
IS 610- M6x40	M6	10	6	5
IS 610- M6x45	M6	10	6	5
IS 610- M6x50	M6	10	6	5
IS 610- M6x60	M6	10	6	5
IS 610- M6x65	M6	10	6	5
IS 610- M6x70	M6	10	6	5
IS 610- M6x75	M6	10	6	5

REF d x L	d	D	k	s
IS 610- M6x80	M6	10	6	5
IS 610- M6x90	M6	10	6	5
IS 610- M6x100	M6	10	6	5
IS 610- M6x110	M6	10	6	5
IS 610- M6x120	M6	10	6	5
IS 610- M8x10	M8	13	8	6
IS 610- M8x12	M8	13	8	6
IS 610- M8x16	M8	13	8	6
IS 610- M8x18	M8	13	8	6
IS 610- M8x20	M8	13	8	6
IS 610- M8x22	M8	13	8	6
IS 610- M8x25	M8	13	8	6
IS 610- M8x30	M8	13	8	6
IS 610- M8x35	M8	13	8	6
IS 610- M8x40	M8	13	8	6
IS 610- M8x45	M8	13	8	6
IS 610- M8x50	M8	13	8	6
IS 610- M8x55	M8	13	8	6
IS 610- M8x60	M8	13	8	6
IS 610- M8x65	M8	13	8	6
IS 610- M8x70	M8	13	8	6
IS 610- M8x75	M8	13	8	6
IS 610- M8x80	M8	13	8	6
IS 610- M8x90	M8	13	8	6
IS 610- M8x100	M8	13	8	6
IS 610- M8x110	M8	13	8	6
IS 610- M8x120	M8	13	8	6
IS 610- M8x130	M8	13	8	6
IS 610- M8x140	M8	13	8	6
IS 610- M8x150	M8	13	8	6
IS 610- M8x160	M8	13	8	6
IS 610- M8x180	M8	13	8	6
IS 610- M8x200	M8	13	8	6
IS 610- M10x16	M10	16	10	8
IS 610- M10x20	M10	16	10	8
IS 610- M10x22	M10	16	10	8
IS 610- M10x25	M10	16	10	8
IS 610- M10x30	M10	16	10	8
IS 610- M10x35	M10	16	10	8
IS 610- M10x40	M10	16	10	8
IS 610- M10x45	M10	16	10	8
IS 610- M10x50	M10	16	10	8
IS 610- M10x55	M10	16	10	8
IS 610- M10x60	M10	16	10	8
IS 610- M10x65	M10	16	10	8
IS 610- M10x70	M10	16	10	8
IS 610- M10x75	M10	16	10	8
IS 610- M10x80	M10	16	10	8
IS 610- M10x90	M10	16	10	8
IS 610- M10x100	M10	16	10	8

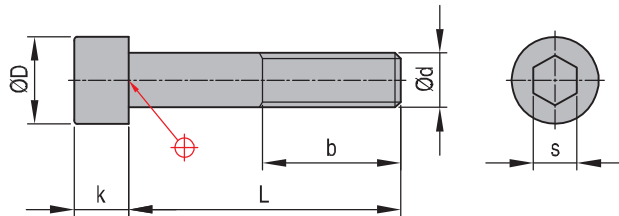
Socket head cap screws DIN 912 - 10,9
IS 610

REF d x L	d	D	k	s
IS 610- M10x110	M10	16	10	8
IS 610- M10x120	M10	16	10	8
IS 610- M10x130	M10	16	10	8
IS 610- M10x140	M10	16	10	8
IS 610- M10x150	M10	16	10	8
IS 610- M10x160	M10	16	10	8
IS 610- M10x170	M10	16	10	8
IS 610- M10x180	M10	16	10	8
IS 610- M10x200	M10	16	10	8
IS 610- M12x20	M12	18	12	10
IS 610- M12x25	M12	18	12	10
IS 610- M12x30	M12	18	12	10
IS 610- M12x35	M12	18	12	10
IS 610- M12x40	M12	18	12	10
IS 610- M12x45	M12	18	12	10
IS 610- M12x50	M12	18	12	10
IS 610- M12x55	M12	18	12	10
IS 610- M12x60	M12	18	12	10
IS 610- M12x65	M12	18	12	10
IS 610- M12x70	M12	18	12	10
IS 610- M12x75	M12	18	12	10
IS 610- M12x80	M12	18	12	10
IS 610- M12x90	M12	18	12	10
IS 610- M12x100	M12	18	12	10
IS 610- M12x110	M12	18	12	10
IS 610- M12x120	M12	18	12	10
IS 610- M12x130	M12	18	12	10
IS 610- M12x140	M12	18	12	10
IS 610- M12x150	M12	18	12	10
IS 610- M12x160	M12	18	12	10
IS 610- M12x170	M12	18	12	10
IS 610- M12x180	M12	18	12	10
IS 610- M12x190	M12	18	12	10
IS 610- M12x200	M12	18	12	10
IS 610- M16x20	M16	24	16	14
IS 610- M16x22	M16	24	16	14
IS 610- M16x25	M16	24	16	14
IS 610- M16x30	M16	24	16	14
IS 610- M16x35	M16	24	16	14
IS 610- M16x45	M16	24	16	14
IS 610- M16x50	M16	24	16	14
IS 610- M16x55	M16	24	16	14
IS 610- M16x60	M16	24	16	14
IS 610- M16x65	M16	24	16	14
IS 610- M16x70	M16	24	16	14
IS 610- M16x75	M16	24	16	14
IS 610- M16x80	M16	24	16	14
IS 610- M16x90	M16	24	16	14
IS 610- M16x100	M16	24	16	14
IS 610- M16x110	M16	24	16	14

REF d x L	d	D	k	s
IS 610- M16x120	M16	24	16	14
IS 610- M16x130	M16	24	16	14
IS 610- M16x140	M16	24	16	14
IS 610- M16x150	M16	24	16	14
IS 610- M16x160	M16	24	16	14
IS 610- M16x170	M16	24	16	14
IS 610- M16x180	M16	24	16	14
IS 610- M16x190	M16	24	16	14
IS 610- M16x200	M16	24	16	14
IS 610- M16x210	M16	24	16	14
IS 610- M16x220	M16	24	16	14
IS 610- M16x240	M16	24	16	14
IS 610- M16x260	M16	24	16	14
IS 610- M16x280	M16	24	16	14
IS 610- M16x300	M16	24	16	14
IS 610- M20x50	M20	30	20	17
IS 610- M20x55	M20	30	20	17
IS 610- M20x60	M20	30	20	17
IS 610- M20x65	M20	30	20	17
IS 610- M20x70	M20	30	20	17
IS 610- M20x75	M20	30	20	17
IS 610- M20x80	M20	30	20	17
IS 610- M20x90	M20	30	20	17
IS 610- M20x100	M20	30	20	17
IS 610- M20x110	M20	30	20	17
IS 610- M20x120	M20	30	20	17
IS 610- M20x130	M20	30	20	17
IS 610- M20x140	M20	30	20	17
IS 610- M20x150	M20	30	20	17
IS 610- M20x160	M20	30	20	17
IS 610- M20x170	M20	30	20	17
IS 610- M20x180	M20	30	20	17
IS 610- M20x190	M20	30	20	17
IS 610- M20x200	M20	30	20	17
IS 610- M20x220	M20	30	20	17
IS 610- M20x240	M20	30	20	17
IS 610- M20x260	M20	30	20	17
IS 610- M20x280	M20	30	20	17
IS 610- M20x300	M20	30	20	17
IS 610- M24x50	M24	36	24	19
IS 610- M24x60	M24	36	24	19
IS 610- M24x70	M24	36	24	19
IS 610- M24x80	M24	36	24	19
IS 610- M24x90	M24	36	24	19
IS 610- M24x150	M24	36	24	19
IS 610- M24x160	M24	36	24	19
IS 610- M24x260	M24	36	24	19



R 54

Spring washers

Mat.: DIN 7980

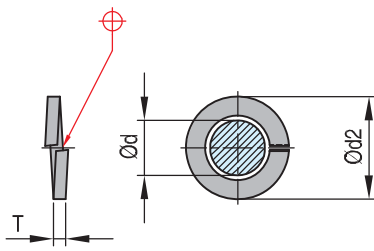

REF d x T	d2	d	T
R 54 4 x 1,2	7	4	1,2
R 54 5 x 1,6	8,8	5	1,6
R 54 6 x 1,6	9,9	6	1,6
R 54 8 x 2	12,7	8	2
R 54 10 x 2,5	16	10	2,5
R 54 12 x 2,5	18	12	2,5
R 54 16 x 3,5	24,4	16	3,5
R 54 20 x 4,5	30,6	20	4,5
R 54 24 x 5	35,9	24	5

R 18

Disks

Mat.: 1.1730

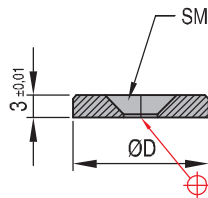

REF	D	SM
R 18 18	18	M4
R 18 28	28	M4

SB

Spacer washers for ejector plates

Mat.: 1.2312

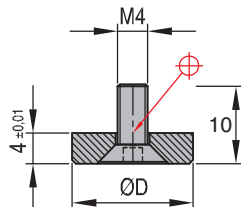

REF	D
SB 2	16
SB 3	26



Socket head countersunk screws

Mat.: DIN 7991-10.9

SM

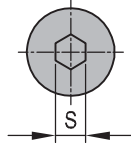
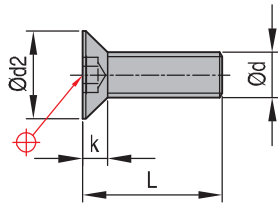

REF d x L	L	d	k	S	d2
SM 3-10	10	M3	1,7	2,0	6
SM 3-12	12	M3	1,7	2,0	6
SM 3-16	16	M3	1,7	2,0	6
SM 3-20	20	M3	1,7	2,0	6
SM 3-25	25	M3	1,7	2,0	6
SM 3-30	30	M3	1,7	2,0	6
SM 4-8	8	M4	2,3	2,5	8
SM 4-10	10	M4	2,3	2,5	8
SM 4-12	12	M4	2,3	2,5	8
SM 4-16	16	M4	2,3	2,5	8
SM 4-20	20	M4	2,3	2,5	8
SM 4-25	25	M4	2,3	2,5	8
SM 4-30	30	M4	2,3	2,5	8
SM 5-10	10	M5	2,8	3,0	10
SM 5-12	12	M5	2,8	3,0	10
SM 5-16	16	M5	2,8	3,0	10
SM 5-20	20	M5	2,8	3,0	10
SM 5-25	25	M5	2,8	3,0	10
SM 5-30	30	M5	2,8	3,0	10
SM 5-40	40	M5	2,8	3,0	10
SM 6-10	10	M6	3,3	4,0	12
SM 6-12	12	M6	3,3	4,0	12
SM 6-16	16	M6	3,3	4,0	12
SM 6-20	20	M6	3,3	4,0	12
SM 6-25	25	M6	3,3	4,0	12
SM 6-30	30	M6	3,3	4,0	12
SM 6-35	35	M6	3,3	4,0	12
SM 6-40	40	M6	3,3	4,0	12
SM 8-16	16	M8	4,4	5,0	16
SM 8-20	20	M8	4,4	5,0	16
SM 8-25	25	M8	4,4	5,0	16
SM 8-30	30	M8	4,4	5,0	16
SM 8-35	35	M8	4,4	5,0	16
SM 8-40	40	M8	4,4	5,0	16
SM 8-45	45	M8	4,4	5,0	16
SM 8-50	50	M8	4,4	5,0	16
SM 10-16	16	M10	5,5	6,0	20
SM 10-20	20	M10	5,5	6,0	20
SM 10-25	25	M10	5,5	6,0	20
SM 10-30	30	M10	5,5	6,0	20
SM 10-35	35	M10	5,5	6,0	20
SM 10-40	40	M10	5,5	6,0	20
SM 10-45	45	M10	5,5	6,0	20
SM 10-50	50	M10	5,5	6,0	20
SM 12-20	20	M12	6,5	8,0	24



GS 913

Grub screws

Mat.: DIN 913-45H

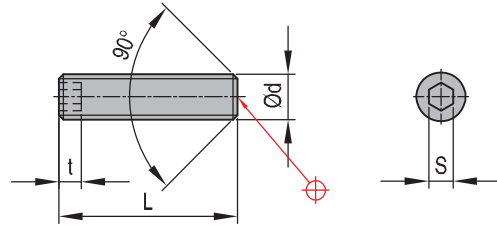

REF d x L	L	d	t	S
GS 913 3-4	4	M3	2,5	1,5
GS 913 3-5	5	M3	2,5	1,5
GS 913 3-6	6	M3	2,5	1,5
GS 913 3-8	8	M3	2,5	1,5
GS 913 3-10	10	M3	2,5	1,5
GS 913 3-16	16	M3	2,5	1,5
GS 913 4-4	4	M4	2,5	2,0
GS 913 4-5	5	M4	2,5	2,0
GS 913 4-6	6	M4	2,5	2,0
GS 913 4-8	8	M4	2,5	2,0
GS 913 4-10	10	M4	2,5	2,0
GS 913 4-12	12	M4	2,5	2,0
GS 913 4-16	16	M4	2,5	2,0
GS 913 4-20	20	M4	2,5	2,0
GS 913 5-5	5	M5	3,0	2,5
GS 913 5-6	6	M5	3,0	2,5
GS 913 5-8	8	M5	3,0	2,5
GS 913 5-10	10	M5	3,0	2,5
GS 913 5-12	12	M5	3,0	2,5
GS 913 5-16	16	M5	3,0	2,5
GS 913 5-20	20	M5	3,0	2,5
GS 913 5-25	25	M5	3,0	2,5
GS 913 6-6	6	M6	3,5	3,0
GS 913 6-8	8	M6	3,5	3,0
GS 913 6-10	10	M6	3,5	3,0
GS 913 6-12	12	M6	3,5	3,0
GS 913 6-16	16	M6	3,5	3,0
GS 913 6-20	20	M6	3,5	3,0
GS 913 6-25	25	M6	3,5	3,0
GS 913 6-30	30	M6	3,5	3,0
GS 913 6-40	40	M6	3,5	3,0
GS 913 8-8	8	M8	5,0	4,0

REF d x L	L	d	t	S
GS 913 8-10	10	M8	5,0	4,0
GS 913 8-12	12	M8	5,0	4,0
GS 913 8-16	16	M8	5,0	4,0
GS 913 8-20	20	M8	5,0	4,0
GS 913 8-25	25	M8	5,0	4,0
GS 913 8-30	30	M8	5,0	4,0
GS 913 8-35	35	M8	5,0	4,0
GS 913 10-10	10	M10	6,0	5,0
GS 913 10-12	12	M10	6,0	5,0
GS 913 10-16	16	M10	6,0	5,0
GS 913 10-20	20	M10	6,0	5,0
GS 913 10-25	25	M10	6,0	5,0
GS 913 10-30	30	M10	6,0	5,0
GS 913 10-35	35	M10	6,0	5,0
GS 913 10-40	40	M10	6,0	5,0
GS 913 10-50	50	M10	6,0	5,0
GS 913 12-12	12	M12	8,0	6,0
GS 913 12-16	16	M12	8,0	6,0
GS 913 12-20	20	M12	8,0	6,0
GS 913 12-25	25	M12	8,0	6,0
GS 913 12-30	30	M12	8,0	6,0
GS 913 12-35	35	M12	8,0	6,0
GS 913 12-40	40	M12	8,0	6,0
GS 913 12-50	50	M12	8,0	6,0
GS 913 16-16	16	M16	10,0	8,0
GS 913 16-20	20	M16	10,0	8,0
GS 913 16-25	25	M16	10,0	8,0
GS 913 16-30	30	M16	10,0	8,0
GS 913 16-35	35	M16	10,0	8,0
GS 913 16-40	40	M16	10,0	8,0
GS 913 16-50	50	M16	10,0	8,0



Grub screws

Mat.: DIN 913-45H

GS 915

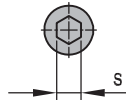
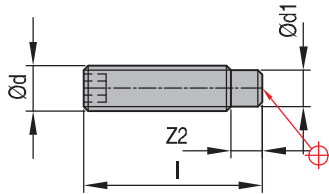

REF d x L	L	d	d1	S	Z2
GS 915 4x10	10	M4	2,5	2	3,0
GS 915 6x10	10	M6	4,0	3	3,5
GS 915 6x16	16	M6	4,0	3	3,5
GS 915 6x20	20	M6	4,0	3	3,5
GS 915 6x25	25	M6	4,0	3	3,5
GS 915 8x20	20	M8	5,5	4	5,0
GS 915 8x25	25	M8	5,5	4	5,0
GS 915 8x30	30	M8	5,5	4	5,0
GS 915 10x20	20	M10	7,0	5	5,5
GS 915 10x25	25	M10	7,0	5	5,5
GS 915 10x30	30	M10	7,0	5	5,5
GS 915 10x40	40	M10	7,0	5	5,5
GS 915 10x50	50	M10	7,0	5	5,5
GS 915 12x20	20	M12	8,5	6	7,0
GS 915 12x25	25	M12	8,5	6	7,0
GS 915 12x30	30	M12	8,5	6	7,0
GS 915 12x35	35	M12	8,5	6	7,0
GS 915 12x40	40	M12	8,5	6	7,0
GS 915 12x50	50	M12	8,5	6	7,0
GS 915 16x30	30	M16	12,0	8	9,0
GS 915 16x40	40	M16	12,0	8	9,0
GS 915 16x45	45	M16	12,0	8	9,0
GS 915 16x60	60	M16	12,0	8	9,0



FD

Spring loaded set screws

Mat.: 1.0716-100°C

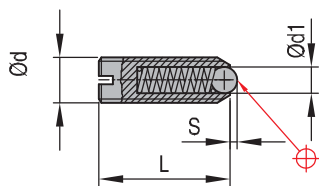

REF d x L	L	d1	S	*N1~	**N2~	d
FD 3 x 7	7	1,5	0,5	2	3	M3
FD 4 x 9	9	2,5	0,8	4	10	M4
FD 5 x 12	12	3,0	0,9	6	11	M5
FD 6 x 14	14	3,5	1,0	9	15	M6
FD 8 x 16	16	5,0	1,5	18	30	M8
FD 10 x 19	19	6,0	2,0	20	40	M10
FD 12 x 22	22	8,0	2,5	30	55	M12
FD 16 x 24	24	10,0	3,5	65	120	M16
FD 20 x 30	30	12,0	4,5	90	140	M20
FD 24 x 34	34	15,0	5,5	125	180	M24

*N1~ = Starting load **N2~ = Final load

FDV

Spring washers

Mat.: 1.4305-350°C

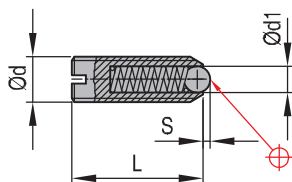

REF d x L	L	d1	S	*N1~	**N2~	d
FDV 3 x 7	7	1,5	0,5	2	3	M3
FDV 4 x 9	9	2,5	0,8	4	10	M4
FDV 5 x 12	12	3	0,9	6	11	M5
FDV 6 x 14	14	3,5	1	9	15	M6
FDV 8 x 16	16	5	1,5	18	30	M8
FDV 10 x 19	19	6	2	20	40	M10
FDV 12 x 22	22	8	2,5	30	55	M12
FDV 16 x 24	24	10	3,5	65	120	M16
FDV 20 x 30	30	12	4,5	90	140	M20
FDV 24 x 34	34	15	5,5	125	180	M24

*N1~ = Starting load **N2~ = Final load

FM

Spring washers

Mat.: 1.0716

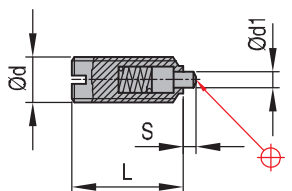

REF d x L	L	d1	S	*N1~	**N2~	d
FM 4 x 9	9	1,8	1,5	6	16	M4
FM 5 x 12	12	2,4	2,0	6	17	M5
FM 6 x 14	14	2,7	2,0	7	18	M6
FM 8 x 16	16	4,0	2,0	20	35	M8
FM 10 x 19	19	4,5	2,5	20	45	M10
FM 12 x 22	22	6,0	3,5	25	60	M12
FM 16 x 24	24	8,5	4,5	50	95	M16
FM 20 x 30	30	10,0	6,5	80	140	M20
FM 24 x 34	34	12,0	8,0	100	180	M24

*N1~ = Starting load **N2~ = Final load

WZ 8090

Spring loaded set screws (with internal hexagon)

Mat.: 1.0716

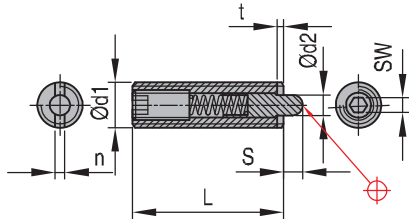

REF d x L	L	d2	n	s	t	SW	*N1~	**N2~	d1
WZ 8090 3 x 12	12	1,0	0,4	1,0	0,5	0,7	1,7	3,5	M3
WZ 8090 4 x 15	15	1,5	0,6	1,5	0,6	1,3	5,0	16,0	M4
WZ 8090 5 x 18	18	2,4	1,2	2,3	0,8	1,5	6,0	20,0	M5
WZ 8090 6 x 20	20	2,7	1,3	2,5	0,9	2,0	7,0	20,0	M6
WZ 8090 8 x 22	22	4,0	1,5	3,0	1,4	2,5	9,0	35,0	M8
WZ 8090 10 x 22	22	4,5	1,5	3,0	1,4	3,0	9,0	35,0	M10
WZ 8090 12 x 28	28	6,0	2,7	4,0	2,0	4,0	10,0	55,0	M12
WZ 8090 16 x 32	32	8,5	3,2	5,0	2,5	5,0	45,0	100,0	M16
WZ 8090 20 x 40	40	10,0	3,5	7,0	3,0	6,0	70,0	140,0	M20
WZ 8090 24 x 52	52	12,0	3,5	10,0	3,0	8,0	80,0	180,0	M24

*N1~ = Starting load **N2~ = Final load

Hexagon socket screw keys-chrome plated

Mat.: 50 CrV4 - DIN 911

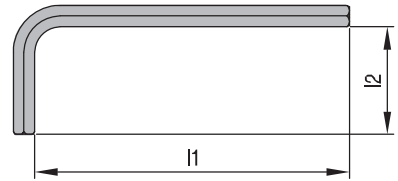
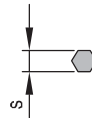
SE 620

REF x s	s	l1	l2	DIN 912	DIN 913-915	DIN 7991
SE 620 x 1,5	1,5	45	14	M1,6-M2	M3	
SE 620 x 2	2,0	50	16	M2,5	M4	
SE 620 x 2,5	2,5	56	18	M3	M5	M3
SE 620 x 3	3,0	63	20	M4	M6	M5
SE 620 x 4	4,0	70	25	M5	M8	M6
SE 620 x 5	5,0	80	28	M6	M10	M8
SE 620 x 6	6,0	90	32	M8	M12-M14	M10
SE 620 x 8	8,0	100	36	M10	M16	M12
SE 620 x 10	10,0	112	40	M12	M18-M20	M14-M16
SE 620 x 12	12,0	125	45	M14	M22-M24	M18-M20
SE 620 x 14	14,0	140	55	M16-M18		M22-M20
SE 620 x 17	17,0	160	63	M20-M22		
SE 620 x 19	19,0	180	70	M24-M27		
SE 620 x 22	22,0	200	80	M30		

Extra long hexagon socket screw keys-chrome plated

Mat.: 50 CrV4 - DIN 911

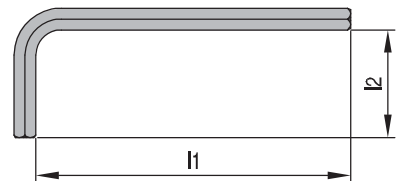
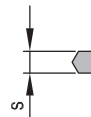
SE 630

REF x s	s	l1	l2	DIN 912	DIN 913-915	DIN 7991
SE 630 x 2	2	100	16	M2,5	M4	
SE 630 x 3	3	126	20	M4	M6	M5
SE 630 x 4	4	140	25	M5	M8	M6
SE 630 x 5	5	160	28	M6	M10	M8
SE 630 x 6	6	180	32	M8	M12-M14	M10
SE 630 x 8	8	200	36	M10	M16	M12
SE 630 x 10	10	224	40	M12	M18-M20	M14-M16
SE 630 x 12	12	250	45	M14	M22-M24	M18-M20
SE 630 x 14	14	280	55	M16-M18		M22-M24

Hexagon socket screw keys with T-handle

Mat.: 50 CrV4 - DIN 911

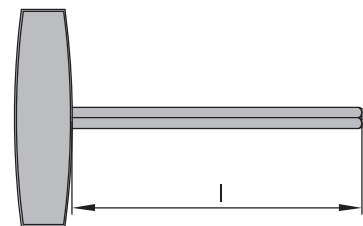
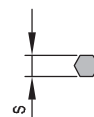
SE 640

REF x s	s	l
SE 640 x 3	3	100
SE 640 x 4	4	100
SE 640 x 5	5	100
SE 640 x 6	6	100
SE 640 x 8	8	100



PM

Shoulder screws

Mat: 35 NC 6 ±1100-1200 N/mm²

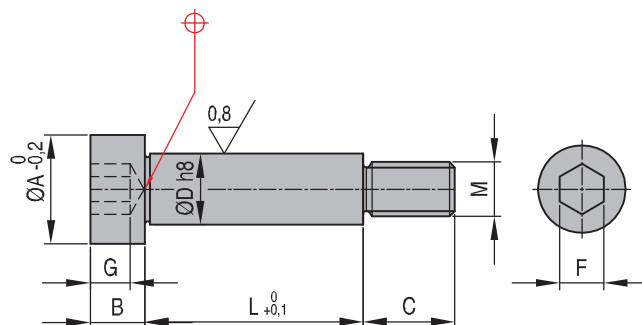

REF M x L	A	B	C	D	F	G
PM 5x6	9	4	8	6	3	2,5
PM 5x8	9	4	8	6	3	2,5
PM 5x10	9	4	8	6	3	2,5
PM 5x12	9	4	8	6	3	2,5
PM 5x14	9	4	8	6	3	2,5
PM 5x16	9	4	8	6	3	2,5
PM 5x20	9	4	8	6	3	2,5
PM 5x25	9	4	8	6	3	2,5
PM 5x30	9	4	8	6	3	2,5
PM 5x32	9	4	8	6	3	2,5
PM 5x40	9	4	8	6	3	2,5
PM 5x50	9	4	8	6	3	2,5
PM 5x60	9	4	8	6	3	2,5
PM 5x63	9	4	8	6	3	2,5
PM 6x6	11	5	10	8	4	3,0
PM 6x8	11	5	10	8	4	3,0
PM 6x10	11	5	10	8	4	3,0
PM 6x12	11	5	10	8	4	3,0
PM 6x14	11	5	10	8	4	3,0
PM 6x16	11	5	10	8	4	3,0
PM 6x20	11	5	10	8	4	3,0
PM 6x25	11	5	10	8	4	3,0
PM 6x30	11	5	10	8	4	3,0
PM 6x32	11	5	10	8	4	3,0
PM 6x40	11	5	10	8	4	3,0
PM 6x50	11	5	10	8	4	3,0
PM 6x60	11	5	10	8	4	3,0
PM 6x70	11	5	10	8	4	3,0
PM 6x80	11	5	10	8	4	3,0
PM 6x90	11	5	10	8	4	3,0
PM 6x100	11	5	10	8	4	3,0
PM 6x110	11	5	10	8	4	3,0
PM 8x6	14	6	12	10	5	4,0
PM 8x8	14	6	12	10	5	4,0
PM 8x10	14	6	12	10	5	4,0
PM 8x12	14	6	12	10	5	4,0
PM 8x14	14	6	12	10	5	4,0
PM 8x16	14	6	12	10	5	4,0
PM 8x20	14	6	12	10	5	4,0
PM 8x25	14	6	12	10	5	4,0
PM 8x30	14	6	12	10	5	4,0
PM 8x32	14	6	12	10	5	4,0
PM 8x40	14	6	12	10	5	4,0
PM 8x50	14	6	12	10	5	4,0
PM 8x60	14	6	12	10	5	4,0
PM 8x70	14	6	12	10	5	4,0
PM 8x80	14	6	12	10	5	4,0
PM 8x90	14	6	12	10	5	4,0
PM 8x100	14	6	12	10	5	4,0
PM 8x110	14	6	12	10	5	4,0

REF M x L	A	B	C	D	F	G
PM 8x120	14	6	12	10	5	4,0
PM 8x125	14	6	12	10	5	4,0
PM 8x140	14	6	12	10	5	4,0
PM 8x160	14	6	12	10	5	4,0
PM 10x8	18	8	16	12	6	5,0
PM 10x10	18	8	16	12	6	5,0
PM 10x12	18	8	16	12	6	5,0
PM 10x14	18	8	16	12	6	5,0
PM 10x16	18	8	16	12	6	5,0
PM 10x20	18	8	16	12	6	5,0
PM 10x25	18	8	16	12	6	5,0
PM 10x30	18	8	16	12	6	5,0
PM 10x32	18	8	16	12	6	5,0
PM 10x40	18	8	16	12	6	5,0
PM 10x50	18	8	16	12	6	5,0
PM 10x60	18	8	16	12	6	5,0
PM 10x70	18	8	16	12	6	5,0
PM 10x80	18	8	16	12	6	5,0
PM 10x90	18	8	16	12	6	5,0
PM 10x100	18	8	16	12	6	5,0
PM 10x110	18	8	16	12	6	5,0
PM 10x120	18	8	16	12	6	5,0
PM 10x125	18	8	16	12	6	5,0
PM 10x140	18	8	16	12	6	5,0
PM 10x160	18	8	16	12	6	5,0
PM 10x200	18	8	16	12	6	5,0
PM 12x10	22	10	20	16	8	6,0
PM 12x12	22	10	20	16	8	6,0
PM 12x14	22	10	20	16	8	6,0
PM 12x16	22	10	20	16	8	6,0
PM 12x20	22	10	20	16	8	6,0
PM 12x25	22	10	20	16	8	6,0
PM 12x30	22	10	20	16	8	6,0
PM 12x32	22	10	20	16	8	6,0
PM 12x40	22	10	20	16	8	6,0
PM 12x50	22	10	20	16	8	6,0
PM 12x60	22	10	20	16	8	6,0
PM 12x70	22	10	20	16	8	6,0
PM 12x80	22	10	20	16	8	6,0
PM 12x90	22	10	20	16	8	6,0
PM 12x100	22	10	20	16	8	6,0
PM 12x110	22	10	20	16	8	6,0
PM 12x120	22	10	20	16	8	6,0
PM 12x125	22	10	20	16	8	6,0
PM 12x140	22	10	20	16	8	6,0
PM 12x160	22	10	20	16	8	6,0
PM 12x200	22	10	20	16	8	6,0
PM 12x250	22	10	20	16	8	6,0
PM 16x16	28	12	25	20	10	8,0
PM 16x20	28	12	25	20	10	8,0

REF M x L	A	B	C	D	F	G
PM 16x25	28	12	25	20	10	8,0
PM 16x30	28	12	25	20	10	8,0
PM 16x32	28	12	25	20	10	8,0
PM 16x40	28	12	25	20	10	8,0
PM 16x50	28	12	25	20	10	8,0
PM 16x60	28	12	25	20	10	8,0
PM 16x70	28	12	25	20	10	8,0
PM 16x80	28	12	25	20	10	8,0
PM 16x90	28	12	25	20	10	8,0
PM 16x100	28	12	25	20	10	8,0
PM 16x110	28	12	25	20	10	8,0
PM 16x120	28	12	25	20	10	8,0
PM 16x125	28	12	25	20	10	8,0
PM 16x140	28	12	25	20	10	8,0
PM 16x160	28	12	25	20	10	8,0
PM 16x200	28	12	25	20	10	8,0
PM 16x250	28	12	25	20	10	8,0
PM 20x20	36	16	32	25	14	11,0
PM 20x25	36	16	32	25	14	11,0
PM 20x30	36	16	32	25	14	11,0
PM 20x32	36	16	32	25	14	11,0
PM 20x40	36	16	32	25	14	11,0
PM 20x50	36	16	32	25	14	11,0
PM 20x60	36	16	32	25	14	11,0
PM 20x70	36	16	32	25	14	11,0
PM 20x80	36	16	32	25	14	11,0
PM 20x90	36	16	32	25	14	11,0
PM 20x100	36	16	32	25	14	11,0
PM 20x110	36	16	32	25	14	11,0
PM 20x120	36	16	32	25	14	11,0
PM 20x125	36	16	32	25	14	11,0
PM 20x140	36	16	32	25	14	11,0
PM 20x160	36	16	32	25	14	11,0
PM 20x200	36	16	32	25	14	11,0
PM 20x250	36	16	32	25	14	11,0
PM 24x50	45	20	40	32	17	12,0
PM 24x60	45	20	40	32	17	12,0
PM 24x70	45	20	40	32	17	12,0
PM 24x80	45	20	40	32	17	12,0
PM 24x90	45	20	40	32	17	12,0
PM 24x100	45	20	40	32	17	12,0
PM 24x110	45	20	40	32	17	12,0
PM 24x120	45	20	40	32	17	12,0
PM 24x125	45	20	40	32	17	12,0
PM 24x160	45	20	40	32	17	12,0
PM 24x200	45	20	40	32	17	12,0
PM 24x250	45	20	40	32	17	12,0



Shoulder screws

 Mat.: Case hardening steel 12.9
DIN 267

WZ 412

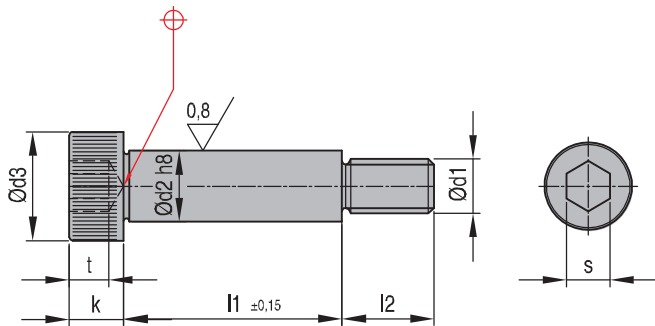

REF d2 x l1	d1	d3	k	l2	S	tmin
WZ 412-6x10	M5	10	4,5	9,5	3	2,4
WZ 412-6x16	M5	10	4,5	9,5	3	2,4
WZ 412-6x20	M5	10	4,5	9,5	3	2,4
WZ 412-6x25	M5	10	4,5	9,5	3	2,4
WZ 412-6x30	M5	10	4,5	9,5	3	2,4
WZ 412-6x40	M5	10	4,5	9,5	3	2,4
WZ 412-6x50	M5	10	4,5	9,5	3	2,4
WZ 412-6x60	M5	10	4,5	9,5	3	2,4
WZ 412-8x16	M6	13	5,5	11,0	4	3,3
WZ 412-8x20	M6	13	5,5	11,0	4	3,3
WZ 412-8x25	M6	13	5,5	11,0	4	3,3
WZ 412-8x30	M6	13	5,5	11,0	4	3,3
WZ 412-8x40	M6	13	5,5	11,0	4	3,3
WZ 412-8x50	M6	13	5,5	11,0	4	3,3
WZ 412-8x60	M6	13	5,5	11,0	4	3,3
WZ 412-8x70	M6	13	5,5	11,0	4	3,3
WZ 412-8x80	M6	13	5,5	11,0	4	3,3
WZ 412-8x90	M6	13	5,5	11,0	4	3,3
WZ 412-8x100	M6	13	5,5	11,0	4	3,3
WZ 412-10x16	M8	16	7,0	13,0	5	4,1
WZ 412-10x20	M8	16	7,0	13,0	5	4,1
WZ 412-10x25	M8	16	7,0	13,0	5	4,1
WZ 412-10x30	M8	16	7,0	13,0	5	4,1
WZ 412-10x40	M8	16	7,0	13,0	5	4,1
WZ 412-10x50	M8	16	7,0	13,0	5	4,1
WZ 412-10x60	M8	16	7,0	13,0	5	4,1
WZ 412-10x70	M8	16	7,0	13,0	5	4,1
WZ 412-10x80	M8	16	7,0	13,0	5	4,1
WZ 412-10x90	M8	16	7,0	13,0	5	4,1
WZ 412-10x100	M8	16	7,0	13,0	5	4,1
WZ 412-12x16	M10	18	9,0	16,0	6	4,9
WZ 412-12x20	M10	18	9,0	16,0	6	4,9
WZ 412-12x25	M10	18	9,0	16,0	6	4,9

REF d2 x l1	d1	d3	k	l2	S	tmin
WZ 412-12x30	M10	18	9,0	16,0	6	4,9
WZ 412-12x40	M10	18	9,0	16,0	6	4,9
WZ 412-12x50	M10	18	9,0	16,0	6	4,9
WZ 412-12x60	M10	18	9,0	16,0	6	4,9
WZ 412-12x70	M10	18	9,0	16,0	6	4,9
WZ 412-12x80	M10	18	9,0	16,0	6	4,9
WZ 412-12x90	M10	18	9,0	16,0	6	4,9
WZ 412-12x100	M10	18	9,0	16,0	6	4,9
WZ 412-12x120	M10	18	9,0	16,0	6	4,9
WZ 412-16x30	M12	24	11,0	18,0	8	6,2
WZ 412-16x40	M12	24	11,0	18,0	8	6,2
WZ 412-16x50	M12	24	11,0	18,0	8	6,2
WZ 412-16x60	M12	24	11,0	18,0	8	6,2
WZ 412-16x70	M12	24	11,0	18,0	8	6,2
WZ 412-16x80	M12	24	11,0	18,0	8	6,2
WZ 412-16x90	M12	24	11,0	18,0	8	6,2
WZ 412-16x100	M12	24	11,0	18,0	8	6,2
WZ 412-16x120	M12	24	11,0	18,0	8	6,2
WZ 412-20x40	M16	30	14,0	22,0	10	8,8
WZ 412-20x50	M16	30	14,0	22,0	10	8,8
WZ 412-20x60	M16	30	14,0	22,0	10	8,8
WZ 412-20x70	M16	30	14,0	22,0	10	8,8
WZ 412-20x80	M16	30	14,0	22,0	10	8,8
WZ 412-20x90	M16	30	14,0	22,0	10	8,8
WZ 412-20x100	M16	30	14,0	22,0	10	8,8
WZ 412-20x120	M20	36	16,0	27,0	12	10
WZ 412-24x50	M20	36	16,0	27,0	12	10
WZ 412-24x60	M20	36	16,0	27,0	12	10
WZ 412-24x70	M20	36	16,0	27,0	12	10
WZ 412-24x80	M20	36	16,0	27,0	12	10
WZ 412-24x90	M20	36	16,0	27,0	12	10
WZ 412-24x100	M20	36	16,0	27,0	12	10
WZ 412-24x120	M20	36	16,0	27,0	12	10