

# Tools & Accessories For Ultrasonic Work

3

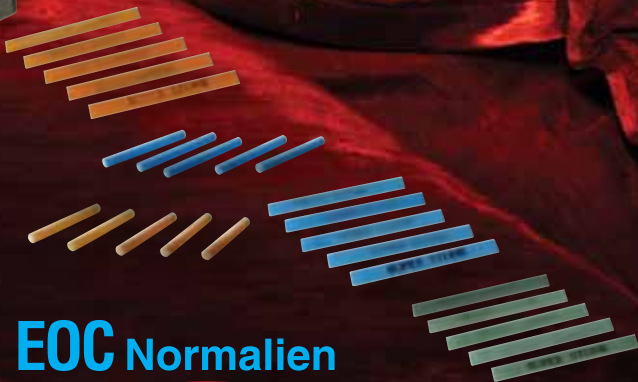

**EOC** Normalien

A **DME** COMPANY



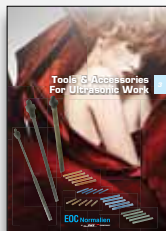

## Tools And Accessories For Ultrasonic Work

Diamond Files.....	2
Ruby & Ceramic Stones .....	8
Tool Clamps .....	10



26/07/2012



UE ... / ME ... / SE ... Electro-bonded

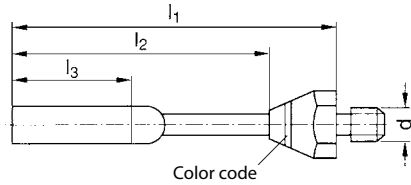

REF	Grain	Color	a x b	l1	l2	l3	d	€	Shape
<b>UE 5851</b>	200	red	1 x 5	145	125	20	M 8	71,69	
<b>UE 5751</b>	320	black	1 x 5	145	125	20	M 8	73,49	
<b>UE 5551</b>	600	white	1 x 5	145	125	20	M 8	73,49	
<b>UE 5881</b>	200	red	1 x 8	145	125	20	M 8	70,27	
<b>UE 5781</b>	320	black	1 x 8	145	125	20	M 8	70,27	
<b>UE 5581</b>	600	white	1 x 8	145	125	20	M 8	70,27	
a x b									
<b>ME 9881</b>	200	red	1 x 8	93	73	20	M 6	68,37	
<b>ME 9781</b>	320	black	1 x 8	93	73	20	M 6	68,37	
<b>ME 9581</b>	600	white	1 x 8	93	73	20	M 6	68,37	
a x b									
<b>ME 9851</b>	200	red	1 x 5	93	73	20	M 6	70,41	
<b>ME 9751</b>	320	black	1 x 5	93	73	20	M 6	68,37	
<b>ME 9551</b>	600	white	1 x 5	93	73	20	M 6	70,41	
a x b									
<b>SE 4841</b>	200	red	1 x 4	37	28	15	M 4	48,16	
<b>SE 4741</b>	320	black	1 x 4	37	28	15	M 4	48,16	
<b>SE 4541</b>	600	white	1 x 4	37	28	15	M 4	48,16	
a x b									
<b>SE 8851</b>	200	red	1 x 5	133	124	40	M 4	67,64	
<b>SE 8751</b>	320	black	1 x 5	133	124	40	M 4	67,64	
<b>SE 8551</b>	600	white	1 x 5	133	124	40	M 4	67,64	
a x b									
<b>SE 5845</b>	200	red	0,5/1x4	44	-	15	M 4	46,74	
<b>SE 5745</b>	320	black	0,5/1x4	44	-	15	M 4	46,74	
<b>SE 5545</b>	600	white	0,5/1x4	44	-	15	M 4	46,74	
a x b									
<b>SE 7841</b>	200	red	4 x 1	34	25	15	M 4	44,98	
<b>SE 7741</b>	320	black	4 x 1	34	25	15	M 4	44,98	
<b>SE 7541</b>	600	white	4 x 1	34	25	15	M 4	44,98	

• upon request

26/07/2012



Electro-bonded

UE ... / ME ... / SE ...

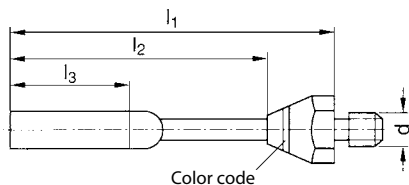

REF	Grain	Color	a	l1	l2	l3	d	€	Shape
<b>SE 3803</b>	200	red	3	34	25	15	M 4	<b>53,83</b>	
<b>SE 3703</b>	320	black	3	34	25	15	M 4	<b>53,83</b>	
<b>SE 3503</b>	600	white	3	34	25	15	M 4	<b>53,83</b>	
<b>d 1</b>									
<b>SE 6803</b>	200	red	3	34	25	15	M 4	<b>47,81</b>	
<b>SE 6703</b>	320	black	3	34	25	15	M 4	<b>47,81</b>	
<b>SE 6503</b>	600	white	3	34	25	15	M 4	<b>47,81</b>	
<b>a x b</b>									
<b>SE 5532</b>	600	white	3 x 2	34	25	15	M 4	<b>51,52</b>	

3

• upon request

26/07/2012



MD ... / SD ...

Sintered

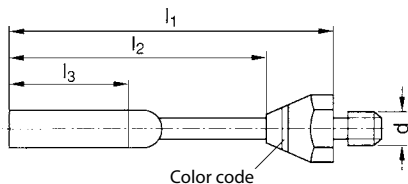

REF	Grain	Color	a x b	l1	l2	l3	d	€	Shape
<b>MD 8862</b>	200	red	1,5 x 6	80	71	15	M 6	72,06	
<b>MD 8762</b>	320	black	1,5 x 6	80	71	15	M 6	72,06	
a x b									
<b>MD 9865</b>	200	red	0,5/1,5x6	80	71	15	M 6	118,29	
<b>MD 9765</b>	320	black	0,5/1,5x6	80	71	15	M 6	118,29	
a x b									
<b>SD 5861</b>	200	red	1,0 x 6	62	53	18	M 4	68,89	
<b>SD 5761</b>	320	black	1,0 x 6	62	53	18	M 4	68,89	
a x b									
<b>SD 5831</b>	200	red	1 x 3	41	32	10	M 4	68,89	
<b>SD 5731</b>	320	black	1 x 3	41	32	10	M 4	68,89	

• upon request

26/07/2012



Sintered

MD ... / SD ...

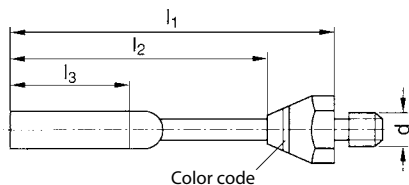

REF	Grain	Color	a x b	l1	l2	l3	d	€	Shape
<b>SD 5851</b>	200	red	1 x 5	41	32	10	M 4	75,65	
<b>SD 5751</b>	320	black	1 x 5	41	32	10	M 4	75,65	
<b>d 1</b>									
<b>SD 1802</b>	200	red	2	37	28	7	M 4	53,12	
<b>SD 1702</b>	320	black	2	37	28	7	M 4	53,12	
<b>SD 1602</b>	500	blue	2	37	28	7	M 4	53,12	
<b>SD 1302</b>	1000	green	2	37	28	7	M 4	53,12	
<b>SD 1803</b>	200	red	3	39	30	10	M 4	53,88	
<b>SD 1703</b>	320	black	3	39	30	10	M 4	53,88	
<b>SD 1603</b>	500	blue	3	39	30	10	M 4	53,88	
<b>SD 1303</b>	1000	green	3	39	30	10	M	53,88	

3



MD ... / SD ...

Sintered

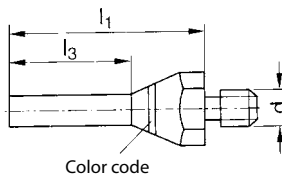

REF	Grain	Color	a x b	l1	l3	d	€	Shape
SD 4831	200	red	1 x 3	24	15	M 4	43,76	
SD 4731	320	black	1 x 3	24	15	M 4	43,76	
SD 4631	500	blue	1 x 3	24	15	M 4	43,76	
SD 4331	1000	green	1 x 3	24	15	M 4	43,76	
SD 4851	200	red	1 x 5	24	15	M 4	51,38	
SD 4751	320	black	1 x 5	24	15	M 4	51,38	
SD 4651	500	blue	1 x 5	24	15	M 4	51,38	
SD 4351	1000	green	1 x 5	24	15	M 4	51,38	
a x b								
SD 4862	200	red	1,5 x 6	34	25	M 4	76,30	
SD 4762	320	black	1,5 x 6	34	25	M 4	76,30	
SD 4662	500	blue	1,5 x 6	34	25	M 4	76,30	
SD 4362	1000	green	1,5 x 6	34	25	M 4	76,30	

• upon request

26/07/2012





Ceramic stones

SC... / LD ...

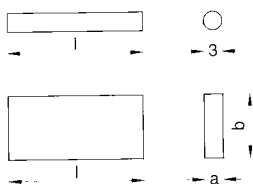

Dimensions 2,0 x 2,0 x 40 mm, available in all grain sizes upon request.

REF	Grain	Shape	Color	a x b	l		€
<b>SC 4948</b>	120	flat	green	0,8 x 4	40	5	77,50
<b>SC 4848</b>	180	flat	gold	0,8 x 4	40	5	77,50
<b>SC 4748</b>	300	flat	light brown	0,8 x 4	40	5	64,95
<b>SC 4648</b>	400	flat	orange	0,8 x 4	40	5	64,95
<b>SC 4548</b>	600	flat	brown	0,8 x 4	40	5	64,95
<b>SC 4448</b>	800	flat	blue	0,8 x 4	40	5	54,31
<b>SC 4348</b>	1000	flat	white	0,8 x 4	40	5	54,31
<b>SC 4248</b>	1200	flat	red	0,8 x 4	40	5	54,31

3



SC ... / LC ...

Ceramic stones

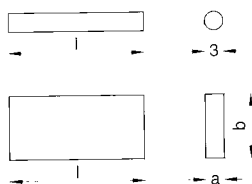

Dimensions 2,0 x 2,0 x 40 mm, available in all grain sizes upon request.

REF	Grain	Shape	Color	a x b	l		€
SC 4968	120	flat	green	0,8 x 6	40	5	96,41
SC 4868	180	flat	gold	0,8 x 6	40	5	96,61
SC 4768	300	flat	light brown	0,8 x 6	40	5	96,61
SC 4668	400	flat	orange	0,8 x 6	40	5	96,61
SC 4568	600	flat	brown	0,8 x 6	40	5	96,61
SC 4468	800	flat	blue	0,8 x 6	40	5	83,27
SC 4368	1000	flat	white	0,8 x 6	40	5	83,27
SC 4268	1200	flat	red	0,8 x 6	40	5	83,27
SC 4941	120	flat	green	1,0 x 4	40	5	67,43
SC 4841	180	flat	gold	1,0 x 4	40	5	67,43
SC 4741	300	flat	light brown	1,0 x 4	40	5	56,31
SC 4641	400	flat	orange	1,0 x 4	40	5	56,31
SC 4541	600	flat	brown	1,0 x 4	40	5	55,64
SC 4441	800	flat	blue	1,0 x 4	40	5	49,64
SC 4341	1000	flat	white	1,0 x 4	40	5	49,64
SC 4241	1200	flat	red	1,0 x 4	40	5	50,30
SC 4961	120	flat	green	1,0 x 6	40	5	97,79
SC 4861	180	flat	gold	1,0 x 6	40	5	97,79
SC 4761	300	flat	light brown	1,0 x 6	40	5	82,63
SC 4661	400	flat	orange	1,0 x 6	40	5	82,63
SC 4561	600	flat	brown	1,0 x 6	40	5	82,63
SC 4461	800	flat	blue	1,0 x 6	40	5	70,29
SC 4361	1000	flat	white	1,0 x 6	40	5	70,64
SC 4261	1200	flat	red	1,0 x 6	40	5	70,64
LC 4962	120	flat	green	2,0 x 6	40	5	122,27
LC 4862	180	flat	gold	2,0 x 6	40	5	122,27
LC 4762	300	flat	light brown	2,0 x 6	40	5	117,60
LC 4662	400	flat	orange	2,0 x 6	40	5	115,60
LC 4562	600	flat	brown	2,0 x 6	40	5	124,26
LC 4462	800	flat	l blue	2,0 x 6	40	5	107,60

• upon request

26/07/2012



Ceramic stones

SC ... / LC ...

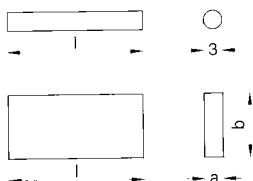

Dimensions 2,0 x 2,0 x 40 mm, available in all grain sizes upon request.

REF	Grain	Shape	Color	a x b	l		€
<b>LC 4362</b>	1000	flat	white	2,0 x 6	40	5	107,60
<b>LC 4262</b>	1200	flat	red	2,0 x 6	40	5	107,60
<b>LC 4912</b>	120	flat	green	2,0 x 12	40	5	230,01
<b>LC 4812</b>	180	flat	gold	2,0 x 12	40	5	.
<b>LC 4712</b>	300	flat	light brown	2,0 x 12	40	5	231,20
<b>LC 4612</b>	400	flat	orange	2,0 x 12	40	5	231,20
<b>LC 4512</b>	600	flat	brown	2,0 x 12	40	5	231,20
<b>LC 4412</b>	800	flat	blue	2,0 x 12	40	5	198,21
<b>LC 4312</b>	1000	flat	white	2,0 x 12	40	5	198,21
<b>LC 4212</b>	1200	flat	red	2,0 x 12	40	5	
$\emptyset$							
<b>SC 1930</b>	120	round	green	3,0	30	5	87,77
<b>SC 1830</b>	180	round	gold	3,0	30	5	87,77
<b>SC 1730</b>	300	round	light brown	3,0	30	5	87,77
<b>SC 1630</b>	400	round	orange	3,0	30	5	87,77
<b>SC 1530</b>	600	round	brown	3,0	30	5	87,77
<b>SC 1430</b>	800	round	blue	3,0	30	5	74,38
<b>SC 1330</b>	1000	round	white	3,0	30	5	74,38
<b>SC 1230</b>	1200	round	red	3,0	30	5	74,38

3



## SX 10 ...

### Tool clamps

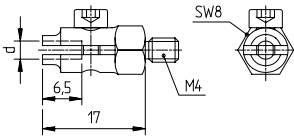

REF	d	€
<b>SX 1002</b>	2	28,30
<b>SX 1003</b>	3	28,30
<b>SX 1004</b>	4	28,30
<b>SX 1005</b>	5	28,30
<b>SX 1006</b>	6	28,30

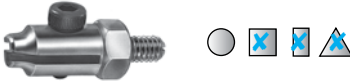

For ultrasonic handpiece UF 9000 and UF 9700 with adaptor Material: steel

## SX 4012

### Tool clamps

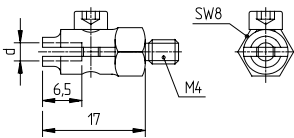

REF	s	€
<b>SX 4012</b>	2	28,30



For ultrasonic handpiece UF 9000 and UF 9700 with adaptor Material: steel

## SX 40 ...

### Tool clamps

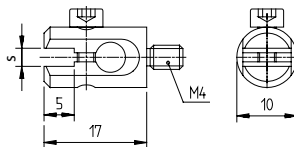

REF	s	€
<b>SX 4008</b>	0.8	28,30
<b>SX 4011</b>	1.1	28,30
<b>SX 4031</b>	3.1	28,30
<b>SX 4033</b>	3.1	28,30



For ultrasonic handpiece UF 9000 and UF 9700 with adaptor Material: steel



## Tool clamps

LX ...

REF	d	€
<b>LX 1000</b>	1,1	.
<b>LX 1010</b>	2,1	13,65

For ultrasonic handpiece UF 7000

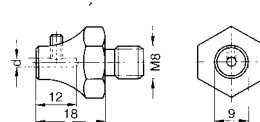

## Adaptors

MS ...

REF	d1	d2	d3	l	€
<b>MS 0064</b>	M4	M6	8	16	.
<b>MS 0086</b>	M6	M8	10	14	11,33

For ultrasonic handpiece UF 9700 and UF 7000 with adaptor Material: steel

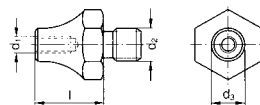

MS 0064  
(for UF 9700)



3



## MX 40 ...

### Tool clamps

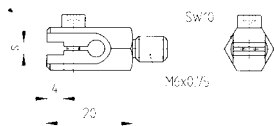

REF	s	€
<b>MX 4008</b>	0,8	30,98
<b>MX 4010</b>	1,0	30,98
<b>MX 4020</b>	2,0	30,98
<b>MX 4030</b>	3,0	30,98
<b>MX 4033</b>	3,3	30,98

For ultrasonic handpiece UF 9700  
Material: steel

## MX 41 ...

### Tool clamps

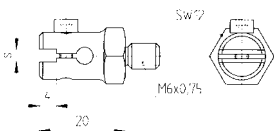

REF	s	€
<b>MX 4110</b>	1,0	30,98
<b>MX 4120</b>	2,0	30,98
<b>MX 4130</b>	3,0	30,98
<b>MX 4133</b>	3,3	30,98
<b>MX 4140</b>	4,0	30,98
<b>MX 4150</b>	5,0	30,98

For ultrasonic handpiece UF 9700  
Material: steel

## MX 10 ...

### Tool clamps

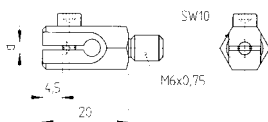

REF	d	€
<b>MX 1020</b>	2,0	30,98
<b>MX 1030</b>	3,0	30,98
<b>MX 1033</b>	3,3	30,98

For ultrasonic handpiece UF 9700  
Material: steel

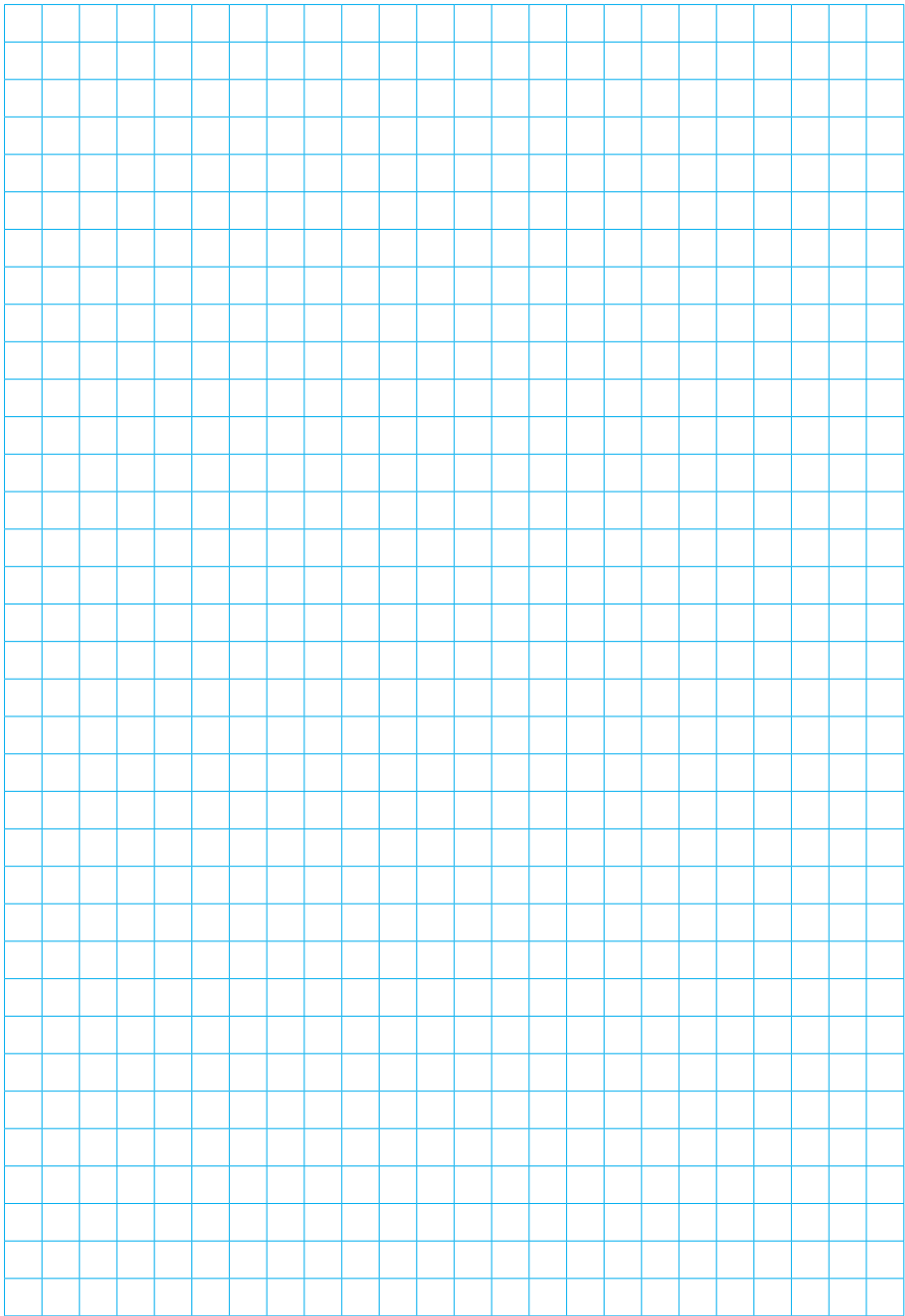

• upon request

26/07/2012

