





>100°



LONG LIFE SERIES

REINFORCED LONG LIFE SERIES: the hot forged parts, as well as hardened and ground pivots and bushings, make this series suitable for heavy duty loads and a long operating life.

TOGGLE MECHANISM: the accessories such as clamping arm and control lever can be welded according to applications for use.

PECULIARITIES AND ADVANTAGES: • The clamping and control levers are forged. • All pivots are hardened and ground and flow into similar bushings. • Red, ergonomic and oil resistant handles. • The clamping arm guide is adjustable.

APPLICATIONS: For uses in medium and heavy duty clamping works, on welding jigs, carpentry works, moulds and generally when high clamping forces are needed and when there is strong repetitiveness of movements.

TOGGLE MECHANISM: Same peculiarities and applications as the previous vertical reinforced series. The design of these mechanisms is more versatile, being possible to weld the different parts and accessories and make up your clamp to better meet the requirements for all types of clamping needs.



O

Q

REINFORCED VERTICAL SERIES WITH FOLDED BASE

Material:

Phosphated steel.

Pivots:

Hardened and ground steel.

Supporting bushes:

Hardened and ground steel.

Handles:

Red polyurethane resistant to oils, grease and other chemical agents.

Performance:

Form A with open clamping lever and two flanged washers.

Form E with eyelet clamping lever to insert the spindle.

Spindles:

To be ordered separately (see Accessories on page 87).

Features and applications:

The clamping levers and control levers are forged; the guide of the clamping lever is adjustable.

This series is usually used for medium and heavy duty clamping works, on welding jigs, carpentry works, moulds and generally when high clamping forces are needed and when there is strong repetitiveness of movements.

FORM LLA

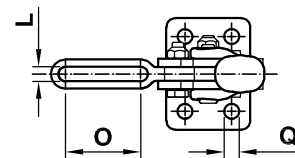
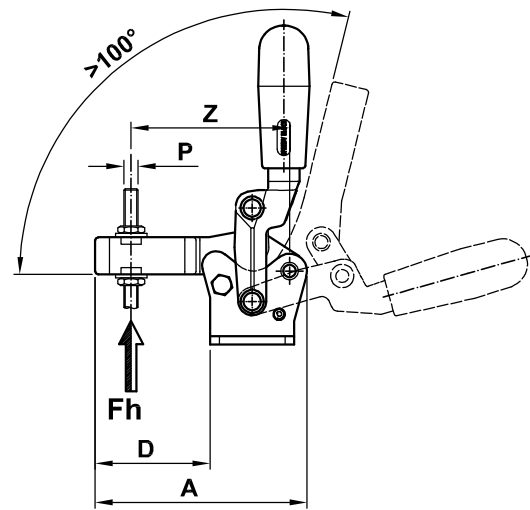

FORM LLE

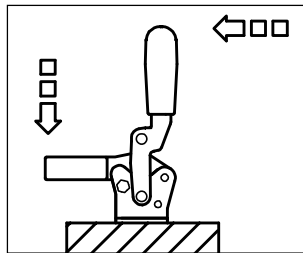
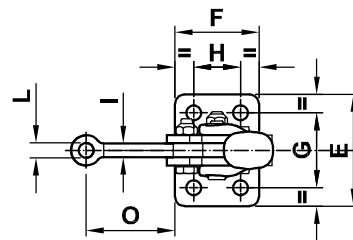
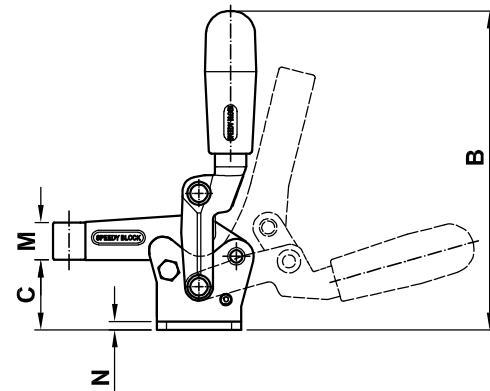

Code	Description	A	B	C	D	E	F	G	H	I	L	M	N	O	P	Q	Z	Fh (daN)	gr.
AA600	LLA01	91	136,5	30	49	48	36	32	20		6,3	16	3,5	32	M6	6,5	77	220	330
AA610	LLE01	86	136,5	30	44	48	36	32	20	6	6,5	16	3,5	38	M6	6,5		220	325
AA630	LLA02	129,5	215	50	64	65	54	45	30		10,3	24	5	34	M10	8,5	107	440	1200
AA640	LLE02	129,5	215	50	64	65	54	45	30	10	10,5	24	5	54,5	M10	8,5		440	1200
AA660	LLE03	161	280	67	74	75	75	55	55	12	12,5	30	6	62	M12	10,5		850	1200
AA680	LLE04	203	330	76,5	96	100	90	65	65	16	16,5	35	8	80	M16	12,5		1540	4510

FORM LLB

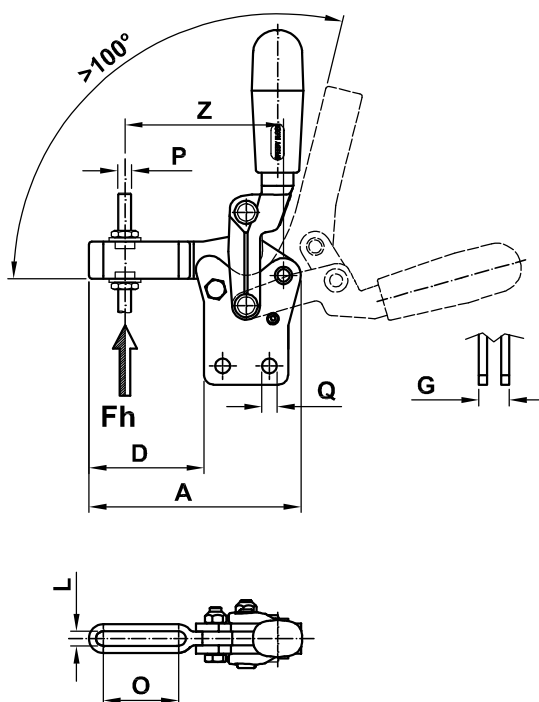

REINFORCED VERTICAL SERIES WITH STRAIGHT BASE

Material:

Phosphated steel.

Pivots:

Hardened and ground steel.

Supporting bushes:

Hardened and ground steel.

Handles:

Red polyurethane resistant to oils, grease and other chemical agents.

Performance:

Form B with open clamping lever and two flanged washers.

Form F with eyelet clamping lever to insert the spindle.

Spindles:

To be ordered separately (see Accessories on page 87).

Features and applications:

The clamping levers and control levers are forged; the guide of the clamping lever is adjustable.

This series is usually used for medium and heavy duty clamping works, on welding jigs, carpentry works, moulds and generally when high clamping forces are needed and when there is strong repetitiveness of movements.

FORM LLF

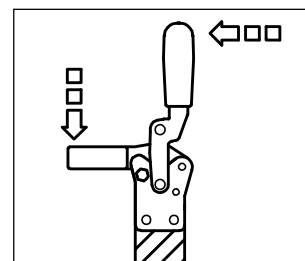
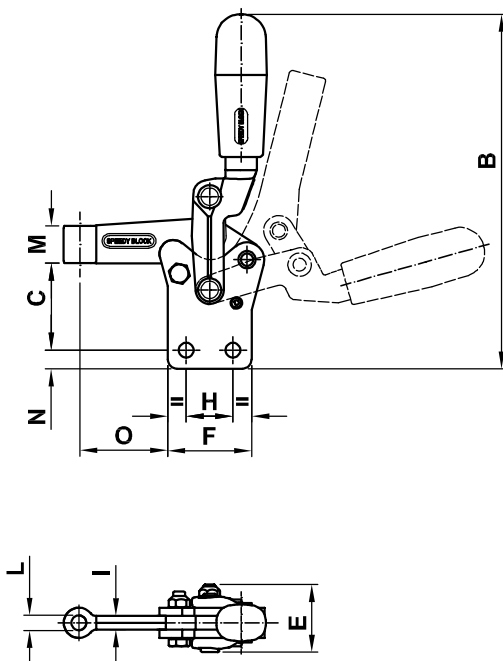

Code	Description	A	B	C	D	E	F	G	H	I	L	M	N	O	P	Q	Z	Fh (daN)	gr.
AA605	LLB01	91	152	37,5	49	29	36	13	20		6,3	16	8	32	M6	6,5	77	220	330
AA615	LLF01	86	152	37,5	44	29	36	13	20	6	6,5	16	8	38	M6	6,5		220	325
AA635	LLB02	129,5	235	59,5	64	42	54	20	30		10,3	24	10	34	M10	8,5	107	440	1200
AA645	LLF02	129,5	235	59,5	64	42	54	20	30	10	10,5	24	10	54,5	M10	8,5		440	1200
AA665	LLF03	161	301	78	74	52	75	24	55	12	12,5	30	10	62	M12	10,5		850	1200
AA685	LLF04	203	330	88,5	96	68	90	32	65	16	16,5	35	17,5	80	M16	12,5		1540	4510

TOGGLE MECHANISMS WITH FOLDED BASE AND STRAIGHT BASE

Material:

Phosphated steel.

Pivots: Hardened and ground steel.

Supporting bushes:

Hardened and ground steel.

Accessories:

To be ordered separately (see Accessories on page 26).

Features and applications:

The clamping and control levers are forged; for uses in medium and heavy duty clamping works, on welding jigs, carpentry works, moulds and generally when high clamping forces are needed and when there is strong repetitiveness of movements.

The design of these mechanisms is more versatile, as it is possible to weld the different parts and accessories and make up your clamp to better meet your requirements.

FORM LSC

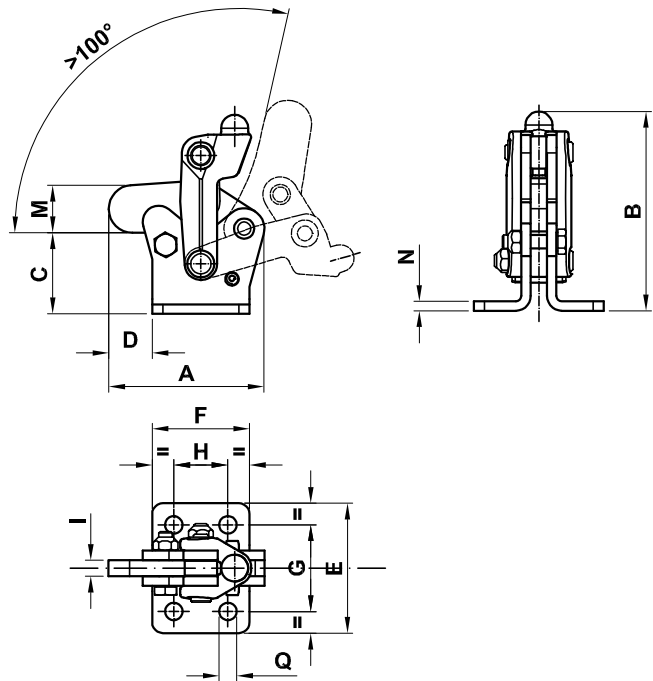

FORM LSG

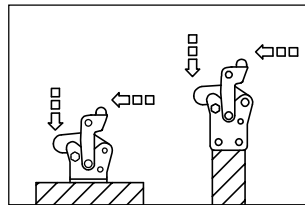
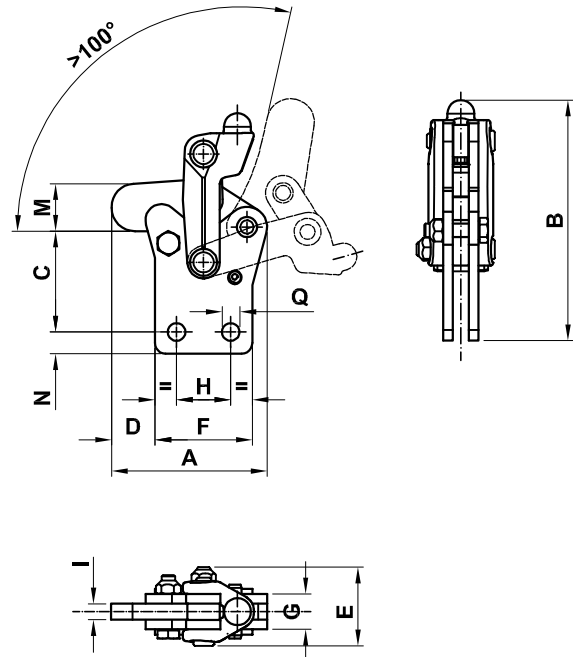

Code	Description	A	B	C	D	E	F	G	H	I	M	N	Q	Fh (daN)	gr.
AA700	LSC01	57,5	71	30	16	48	36	32	20	6	17,5	3,5	6,5	220	256
AA725	LSC02	85,5	121	50	20	65	54	45	30	10	28	5	8,5	440	967
AA750	LSC03	115	158	67	28	75	75	55	55	12	35	6	10,5	850	1900
AA775	LSC04	147,5	193	76,5	40,5	100	90	65	65	16	40,5	8	12,5	1540	3980

Code	Description	A	B	C	D	E	F	G	H	I	M	N	Q	Fh (daN)	gr.
AA705	LSG01	57,5	86	37,5	16	29	36	13	20	6	17,5	8	6,5	220	256
AA730	LSG02	85,5	140,5	59,5	20	42,5	54	20	30	10	28	10	8,5	440	967
AA755	LSG03	115	180	78	28	52	75	24	55	12	35	10	10,5	850	1900
AA780	LSG04	147,5	222	88,5	40,5	68	90	32	65	16	40,5	17,5	12,5	1540	3980

FORM LSH

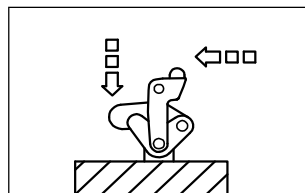
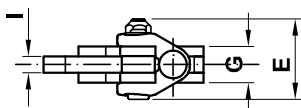
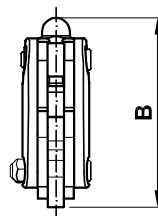
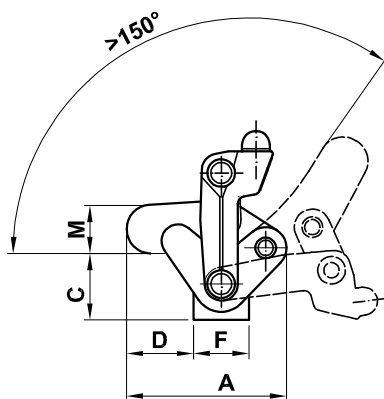

TOGGLE MECHANISM WITH SWINGING BASE

Material:

Phosphated steel.

Pivots: Hardened and ground steel.

Supporting bushes:

Hardened and ground steel.

Accessories:

To be ordered separately (see Accessories on page 26).

Features and applications:

The clamping and control levers are forged; for uses in medium and heavy duty clamping works, on welding jigs, carpentry works, moulds and generally when high clamping forces are needed and when there is strong repetitiveness of movements.

The design of these mechanisms is more versatile, as it is possible to weld the different parts and accessories and make up your clamp to better meet your requirements.

Code	Description	A	B	C	D	E	F	G	I	M	Fh (daN)	gr.
AA710	LSH01	57,5	68	24	24	29	20	13	6	17,5	220	268
AA735	LSH02	85,5	113	42	32	42	30	20	10	28	440	820
AA760	LSH03	115	148	57	40,5	52	50	24	12	35	850	1600
AA785	LSH04	147,5	183	66,5	55,5	68	60	32	16	40,5	1540	3450

Per avere maggiori informazioni tecniche e scaricare i disegni tecnici in formato 2D-3D visita il sito

www.speedyblock.com

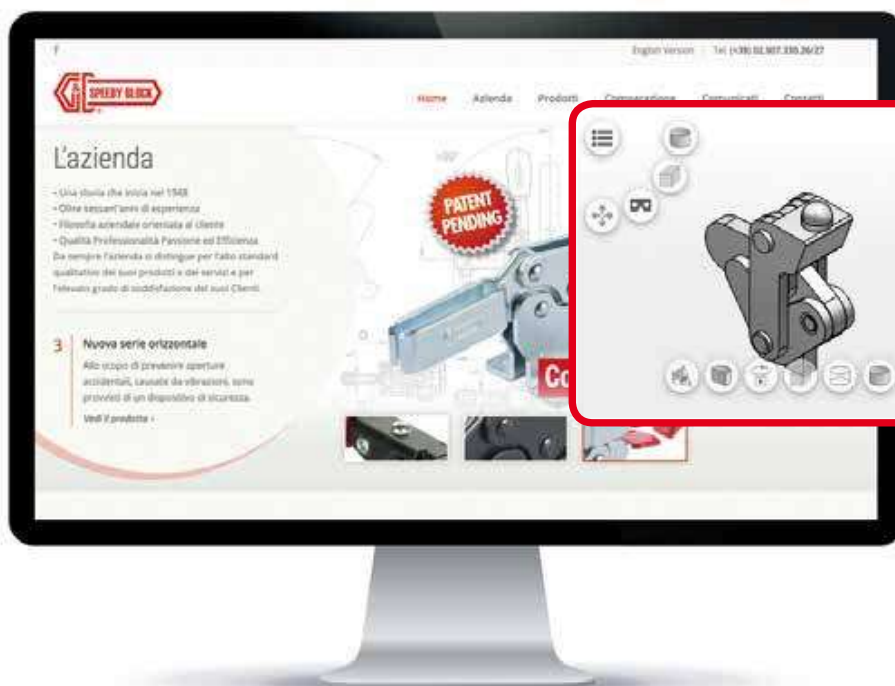

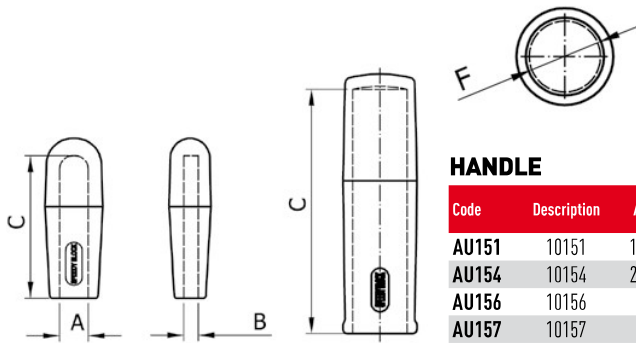

HANDLE

Code	Description	A	B	C	F	gr. ⚖️
AU151	10151	13	5	55		12
AU154	10154	20	8	77		34
AU156	10156			112	22	50
AU157	10157			112	25	50

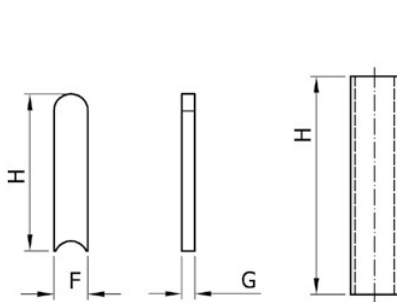

CONTROL LEVER

Code	Description	F	G	H	gr. ⚖️
AU250	LC01	13	5	63	31
AU255	LC02	20	8	90	108
AU260	LC03	22		122	122
AU265	LC04	25		138	175

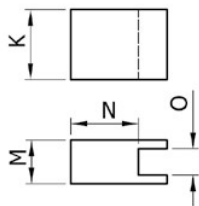

CLAMPING LEVER

Code	Description	K	M	N	O	gr. ⚖️
AU230	LS01	16	10	15,5	6	23
AU235	LS02	24	15	24	10	75,5
AU240	LS03	30	20	22,1	12	130
AU245	LS04	35	25	23,5	16,2	160

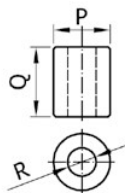

SLEEVE

Code	Description	P	Q	R	gr. ⚖️
AU280	LM01	13	16	6,5	13
AU285	LM02	20	24	10,5	42
AU290	LM03	24	30	12,5	76
AU295	LM04	32	35	16,5	120

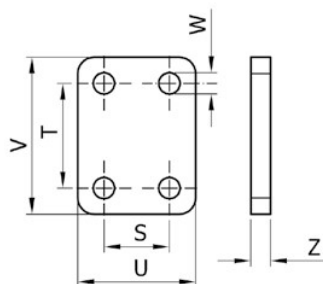

BASE

Code	Description	S	T	U	V	W	Z	gr. ⚖️
AU300	PB01	20	32	36	48	6,5	6	74
AU305	PB02	30	45	54	65	8,5	8	205
AU310	PB03	55	55	75	75	10,5	10	400
AU315	PB04	65	65	90	100	12,5	10	570

