

















PC2201	PC2242	PH1105	PC2301	96
				
		PC2203	PH1103	97
				
		PC2204	PH1104	98
				
	PC2304	PC2216	PC2251	99
				
	PC2206	PC2250	PC2272	100
				
	PC2290	PC2290-CH	PC2290-TX	101
				

NOTE TECNICHE:
FILETTI CILINDRICI BSPP
SECONDO STD. ISO 228,
CONICI BSPT STD. ISO 7.
IL COLORE ED IL
DISEGNO DEI PRODOTTI
FORNITI POTREBBE
DIFFERIRE
LEGGERMENTE
RISPETTO ALLE FOTO
VISIBILI SUL CATALOGO,
FATTO SALVO IL
RISPETTO DELLE
CARATTERISTICHE
TECNICHE E
FUNZIONALI DEI
PRODOTTI.

TECHNICAL NOTICES:
BSPP PARALLEL
THREADS ACCORDING
TO STD. ISO 228;
CONICAL THREADS
BSPT STD. ISO 7. THE
COLOUR AND THE
DESIGN OF THE
PRODUCTS COULD BE
SLIGHTLY DIFFERENT
FROM THE PICTURES
OF THE CATALOGUE.
TECHNICAL AND
FUNCTIONAL FEATURES
WILL BE RESPECTED.

PC2201 TAPPO DIN 906 IN OTTONE NICHELATO* CON FILETTO CONICO BSPT
 DIN 906 NICKEL PLATED* BRASS PLUG WITH BSPT CONICAL THREAD

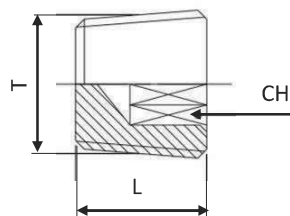
Codice-Code	CH	L	ØT	max bar	
* PC2201-M006	3	6	M6	18	25
* PC2201-M008	4	8	M8x0,75		25
* PC2201-M010	5	8	M10x1		25
* PC2201-M012	6	10	M12x1,5		15
* PC2201-M014	7	10	M14x1,5		10
PC2201-R018	5	8	R1/8"		25
PC2201-R014	6	10	R1/4"		25
PC2201-R038	8	10,5	R3/8"		25
PC2201-R012	10	13	R1/2"		20
PC2201-R034	14	15,5	R3/4"		15
PC2201-R100	17	17,5	R1"		10
* PC2201-R114	14	22	R1"-1/4		10
* PC2201-R112	17	22	R1"-1/2		10

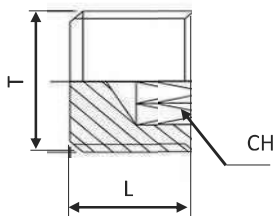
PC2242 TAPPO IN OTTONE NICHELATO* SENZA TESTA CON FILETTO CILINDRICO BSPP
 NICKEL PLATED* BRASS PLUG WITH PARALLEL BSPP THREAD

Codice-Code	CH	L	ØT	max bar	
PC2242-M008	4	8	M8x0,75	18	25
PC2242-M010	5	8	M10x1		25
PC2242-M012	6	8	M12x1,5		15
PC2242-M014	7	10	M14x1,5		10
* PC2242-M020	10	10	M20x1,5		10
* PC2242-M022	12	14	M22x1,5		10
PC2242-G018	5	8	G1/8"		25
PC2242-G014	7	10	G1/4"		25
PC2242-G038	8	10	G3/8"		25
PC2242-G012	10	10	G1/2"		20

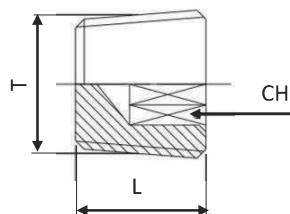
PH1105 TAPPO DIN 906 IN ACCIAIO FOSFATATO CON FILETTO CONICO BSPT
 DIN 906 STEEL PLUG WITH BSPT CONICAL THREAD

Codice-Code	CH	L	ØT	max Bar	
PH1105-M008	4	8	M8x1	350	10
PH1105-M010	5	8	M10x1	350	10
PH1105-M012	6	10	M12x1,5	350	10
PH1105-M014	7	10	M14x1,5	350	10
PH1105-M016	8	10	M16x1,5	350	10
PH1105-M018	8	10	M18x1,5	250	10
PH1105-M020	10	10	M20x1,5	250	10
PH1105-M022	10	10	M22x1,5	225	10
PH1105-M024	12	12	M24x1,5	225	10
PH1105-M026	12	12	M26x1,5	225	10
PH1105-M030	17	17	M30x1,5	200	10
PH1105-R018	5	8	R1/8"	350	10
PH1105-R014	7	10	R1/4"	350	10
PH1105-R038	8	10	R3/8"	250	10
PH1105-R012	10	10	R1/2"	225	10
PH1105-R034	12	12	R3/4"	200	5
PH1105-R100	17	12	R1"	160	5
PH1105-R114	22	18	R1" 1/4	160	5
PH1105-R112	24	20	R1" 1/2	160	5

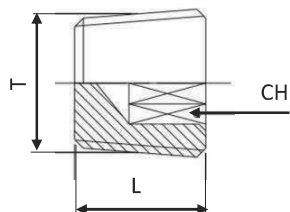
PC2301 TAPPO DIN 906 IN AISI 304 CON FILETTO CONICO BSPT
 DIN 906 STAINLESS STEEL PLUG WITH BSPT CONICAL THREAD

Codice-Code	CH	L	T	max Bar	
PC2301-R018	5	8,2	R1/8"	150	10
PC2301-R014	6	10,2	R1/4"	150	10
PC2301-R038	8	11,6	R3/8"	150	10
PC2301-R012	10	13,3	R1/2"	150	10
PC2301-R034	12	15	R3/4"	150	10
PC2301-R100	17	19	R1"	120	5
PC2301-R114	22	22	R1"1/4	120	5
PC2301-R112	24	22	R1"1/2	120	5

PC2203 TAPPO DIN 908 IN OTTONE NICHELATO* FILETTO BSPP
DIN 908 NICKEL PLATED* BRASS PLUG WITH BSPP PARALLE THREAD

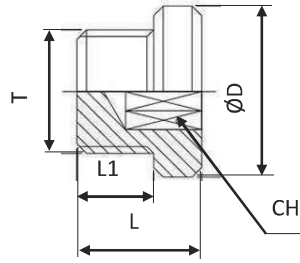

Codice-Code	CH	ØD	L	L1	ØT	max bar	
* PC2203-M010	5	14	11	8	M10x1	18	25
* PC2203-M012	6	17	15	12	M12x1,5		25
* PC2203-M014	6	19	15	12	M14x1,5		25
* PC2203-M020	10	25	16	13	M20x1,5		25
PC2203-G018	5	15	10	6	G1/8"		25
PC2203-G014	6	18	12	8	G1/4"		25
PC2203-G038	8	21	13	9	G3/8"		20
PC2203-G012	10	25	14,5	10	G1/2"		15
* PC2203-G034	12	32	20	15	G3/4"		10
* PC2203-G100	17	39	21	16	G1"		10

*: Ottone giallo – Yellow Brass

PH1103 TAPPO DIN 908 IN ACCIAIO ZINCATO FILETTO CILINDRICO BSPP
DIN 908 GALVANIZED STEEL PLUG WITH BSPP PARALLEL THREAD

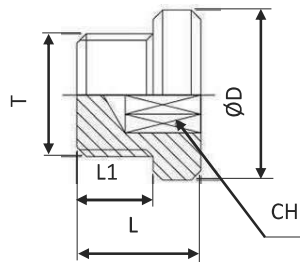

Codice-Code	CH	ØD	L	L1	ØT	max Bar	
PH1103-M008	4	12	11	8	M8x1	400	25
PH1103-M010	5	14	11	8	M10x1	400	25
PH1103-M012	6	17	15	12	M12x1,5	400	25
PH1103-M014	6	19	15	12	M14x1,5	400	10
PH1103-M016	8	21	15	12	M16x1,5	400	10
PH1103-M018	8	23	16	12	M18x1,5	400	10
PH1103-M020	10	25	18	14	M20x1,5	400	10
PH1103-M022	10	27	18	14	M22x1,5	400	10
PH1103-M024	12	29	18	14	M24x1,5	300	5
PH1103-M026	12	31	20	16	M26x1,5	250	5
PH1103-M027	12	32	20	16	M27x2	250	5
PH1103-M030	17	36	20	16	M30x1,5	250	5
PH1103-M033	17	39	21	16	M33x2	250	5
PH1103-M048	22	49	22	16	M48x2	250	5
PH1103-G018	5	14	11	8	G1/8"	400	25
PH1103-G014	6	18	15	12	G1/4"	400	25
PH1103-G038	8	22	15	12	G3/8"	400	10
PH1103-G012	10	26	18	14	G1/2"	400	10
PH1103-G034	12	32	20	16	G3/4"	400	5
PH1103-G100	17	39	21	16	G1"	400	5
PH1103-G114	22	49	21	16	G3/4"	250	5
PH1103-G112	24	55	21	16	G1"	250	5

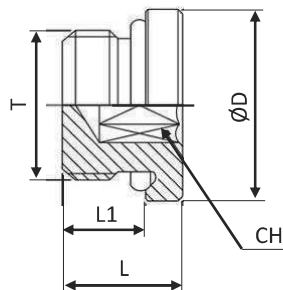

VEDI PAG. 123
SEE PAGE 123

PC2204 TAPPO IN OTTONE NICHELATO* FILETTO CILINDRICO BSPP ED O-RING
 NICKEL PLATED* BRASS WITH BSPP PARALLEL THREAD PLUG AND O-RING

	Codice-Code	CH	ØD	L	L1	ØT	max bar	
OR NBR	PC2204-M005-N	2,5	8	7,2	4,5	M5	18	25
OR FKM	PC2204-M005-V	2,5	8	7,2	4,5	M5		25
OR NBR	PC2204-G018-N	5	14	9,5	6,5	G1/8"		25
OR FKM	PC2204-G018-V	5	14	9,5	6,5	G1/8"		25
OR NBR	PC2204-G014-N	6	17	11,5	8	G1/4"		25
OR FKM	PC2204-G014-V	6	17	11,5	8	G1/4"		25
OR NBR	PC2204-G038-N	8	20	12,5	28	G3/8"		20
OR FKM	PC2204-G038-V	8	20	12,5	9	G3/8"		20
OR NBR	PC2204-G012-N	10	26	14	9	G1/2"		15
OR FKM	PC2204-G012-V	10	26	14	10	G1/2"		15
*	OR NBR	PC2204-G034-N	12	32	20	G3/4"		10
*	OR NBR	PC2204-G100-N	17	39	21	G1"		5
*	OR NBR	PC2204-G114-N	22	47	24	G1"		5

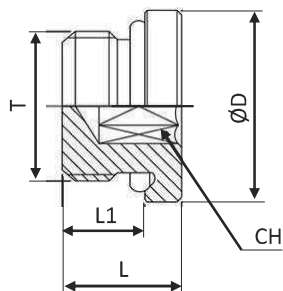
PH1104 TAPPO DIN 908 IN ACCIAIO ZINCATO FILETTO CILINDRICO BSPP ED O-RING
 DIN 908 GALVANIZED STEEL BSPP PARALLEL THREAD PLUG AND O-RING

	Codice-Code	CH	ØD	L	L1	ØT	max Bar	
OR NBR	PH1104-M010-N	5	14	12	8	M10x1	400	10
OR FKM	PH1104-M010-V	5	14	12	8	M10x1	400	10
OR NBR	PH1104-M012-N	6	17	17	12	M12x1,5	400	10
OR FKM	PH1104-M012-V	6	17	17	12	M12x1,5	400	10
OR NBR	PH1104-M014-N	6	19	17	12	M14x1,5	400	10
OR FKM	PH1104-M014-V	6	19	17	12	M14x1,5	400	10
OR NBR	PH1104-M016-N	8	22	17	12	M16x1,5	400	10
OR FKM	PH1104-M016-V	8	22	17	12	M16x1,5	400	10
OR NBR	PH1104-M018-N	8	24	17	12	M18x1,5	400	10
OR FKM	PH1104-M018-V	8	24	17	12	M18x1,5	400	10
OR NBR	PH1104-M020-N	10	26	19	14	M20x1,5	400	10
OR FKM	PH1104-M020-V	10	26	19	14	M20x1,5	400	10
OR NBR	PH1104-M022-N	10	27	19	14	M22x1,5	400	10
OR FKM	PH1104-M022-V	10	27	19	14	M22x1,5	400	10
OR NBR	PH1104-M027-N	12	32	21	16	M27x2	400	5
OR FKM	PH1104-M027-V	12	32	21	16	M27x2	400	5
OR NBR	PH1104-G018-N	5	14	12	8	G1/8"	400	10
OR FKM	PH1104-G018-V	5	14	12	8	G1/8"	400	5
OR NBR	PH1104-G014-N	6	19	17	12	G1/4"	400	10
OR FKM	PH1104-G014-V	6	19	17	12	G1/4"	400	5
OR NBR	PH1104-G038-N	8	22	17	12	G3/8"	400	10
OR FKM	PH1104-G038-V	8	22	17	12	G3/8"	400	5
OR NBR	PH1104-G012-N	10	27	19	14	G1/2"	400	10
OR FKM	PH1104-G012-V	10	27	19	14	G1/2"	400	5
OR NBR	PH1104-G034-N	12	32	21	16	G3/4"	400	5
OR FKM	PH1104-G034-V	12	32	21	16	G3/4"	400	5
OR NBR	PH1104-G100-N	17	40	22,5	16	G1"	400	5
OR FKM	PH1104-G100-V	17	40	22,5	16	G1"	400	5
OR NBR	PH1104-G114-N	22	50	22,5	16	G1"1/4	250	5
OR FKM	PH1104-G114-V	22	50	22,5	16	G1"1/4	250	5
OR NBR	PH1104-G112-N	24	55	22,5	16	G1"1/2	250	5
OR FKM	PH1104-G112-V	24	55	22,5	16	G1"1/2	250	5

PC2304 TAPPO IN AISI 304 FILETTO CILINDRICO BSPP ED O-RING FKM 180°C
STAINLESS STEEL PLUG WITH BSPP PARALLEL THREAD AND FKM OR 180°C

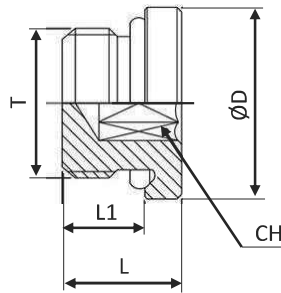

Codice-Code	CH	ØD	L	L1	T	max Bar	
PC2304-G018-V	5	14	12	8	G1/8"	400	10
PC2304-G014-V	6	19	17	12	G1/4"	400	10
PC2304-G038-V	8	22	17	12	G3/8"	400	10
PC2304-G012-V	10	27	19	14	G1/2"	400	10
PC2304-G034-V	12	32	21	16	G3/4"	400	10
PC2304-G100-V	17	40	22,5	16	G1"	400	10
PC2304-G114-V	12	50	22,5	16	G1"1/4	250	10
PC2304-G112-V	17	55	22,5	16	G1"1/2	250	10

PC2216 TAPPO IN OTTONE CON FILETTO FEMMINA BSPP
BSPP FEMALE THREAD BRASS PLUG

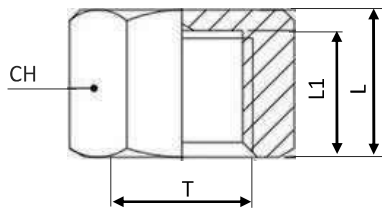

Codice-Code	CH	ØD	L	L1	ØT	max Bar	
PC2216-M005	8	-	7	5,5	M5	25	10
PC2216-G018	14	-	11	9	G1/8"	25	10
PC2216-G014	17	-	13	11	G1/4"	25	10
PC2216-G038	21	-	13,5	11	G3/8"	25	10
PC2216-G012	24	-	13,5	11	G1/2"	20	10
PC2216-G034	30	-	15	12,5	G3/4"	20	5
PC2216-G100	38	-	15	12,5	G1"	15	5

TAPPO CHIUSURA A SFERA
BALL SEALING PLUG

PC2251

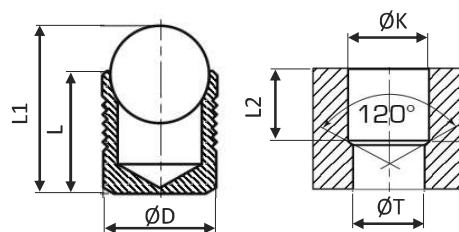

Codice-Code	ØD	ØK +0.10/-0	L	L1	L2	ØT max	
PC2251-03	3	3	3,6	4,6	3,4	2,2	100
PC2251-04	4	4	4	5,2	3,8	3,3	100
PC2251-05	5	5	5,5	7,1	5,3	4,3	100
PC2251-06	6	6	6,5	8,6	6,3	5,3	100
PC2251-07	7	7	7,5	10,1	7,3	6,4	100
PC2251-08	8	8	8,5	11,6	8,3	7,4	100
PC2251-09	9	9	10	13,6	9,8	8,4	50
PC2251-10	10	10	11	15,1	10,8	9,4	50
PC2251-12	12	12	13	17,9	12,8	10,6	50
PC2251-14	14	14	15	20,6	14,5	12,7	50
PC2251-16	16	16	17	23,4	16,5	14,7	25
PC2251-18	18	18	19	26,4	18,5	16,7	25
PC2251-20	20	20	22	30,1	21,45	18,7	25
PC2251-22	22	22	25	34	24,5	20,7	25

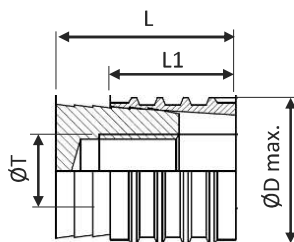
PC2206 TAPPO IN OTTONE-ACCIAIO INOX A PRESSIONE SENZA FILETTO
 THREADLESS BRASS-STAINLESS STEEL PRESSURE PLUG

Codice-Code	ØD max	L	L1	ØT	
-------------	-----------	---	----	----	--

PC2206-06	6	11.5	8	M3	20
PC2206-08	8	11.5	8	M4	20
PC2206-10	10	14	10	M6	20
PC2206-12	12	14	10	M6	15
PC2206-15	15	16	12	M8	10
PC2206-16	16	16	12	M8	10
PC2206-20	20	16	12	M8	10

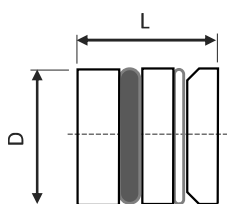
PC2250 TAPPO IN OTTONE AD ESPANSIONE CON O-RING FKM
 THREADLESS PRESSURE BRASS PLUG WITH FKM O-RING

Codice-Code	ØD	L	L1	ØT	
-------------	----	---	----	----	--

PC2250-060	6	10	-	-	10
PC2250-070	7	10	-	-	10
PC2250-080	8	10	-	-	10
PC2250-085	8,5	10	-	-	10
PC2250-100	10	10	-	-	10
PC2250-115	11,5	10	-	-	10
PC2250-120	12	10	-	-	10

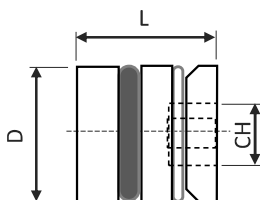
PC2272 TAPPO IN OTTONE AD ESPANSIONE CON O-RING FKM CHIAVE ESAGONALE
 THREADLESS PRESSURE BRASS PLUG WITH FKM O-RING INNER HEXAGON

Codice-Code	ØD	L	L1	ØT	
-------------	----	---	----	----	--

PC2272-140	14	12	-	-	10
PC2272-150	15	12	-	-	10
PC2272-160	16	12	-	-	10
PC2272-200	20	12	-	-	10
PC2272-220	22	12	-	-	10

PC2290 TAPPO AD ESPANSIONE IN OTTONE ZINCATO CON ANELLO DI TENUTA MECCANICA E O-RING FKM
GALVANIZED BRASS THTHREADLESS PLUG WITH LOCKING RING AND FKM O-RING

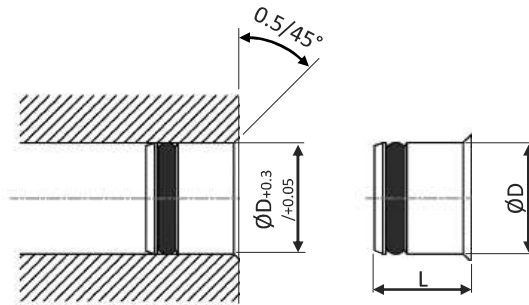

Codice-Code	$\varnothing D$	L	TORX	max bar	
PC2290-06-B	6	≤7	T6	25	25
PC2290-08-B	8	≤9.5	T10		25
PC2290-10-B	10	≤10	T10		25
PC2290-11-B	11	≤11	T10		20
PC2290-12-B	12	≤11	T10		15
PC2290-14-B	14	≤12.5	T27		10
PC2290-15-B	15	≤12.5	T27		10
PC2290-16-B	16	≤12.5	T27		10
PC2290-20-B	20	≤13.5	T27		5
PC2290-25-B	25	≤13.5	T27		5

PC2290 TAPPO AD ESPANSIONE IN AISI 304 CON ANELLO DI TENUTA MECCANICA E O-RING FKM
AISI 304 THTHREADLESS PLUG WITH LOCKING RING AND FKM O-RING

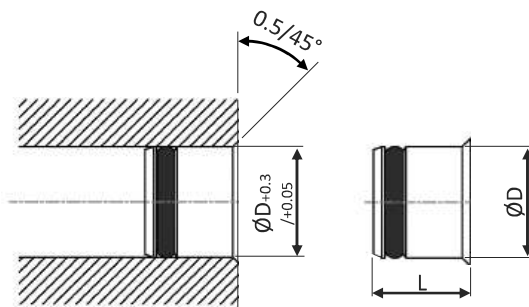

Codice-Code	$\varnothing D$	L	TORX	max bar	
PC2290-06-S	6	≤7	T6	25	25
PC2290-08-S	8	≤9.5	T10		25
PC2290-10-S	10	≤10	T10		25
PC2290-11-S	11	≤11	T10		20
PC2290-12-S	12	≤11	T10		15
PC2290-14-S	14	≤12.5	T27		10
PC2290-15-S	15	≤12.5	T27		10
PC2290-16-S	16	≤12.5	T27		10
PC2290-20-S	20	≤13.5	T27		5
PC2290-25-S	25	≤13.5	T27		5

PC2290-CH CHIAVE PER INSTALLAZIONE PC2290
INSTALLATION TOOL FOR PC2290

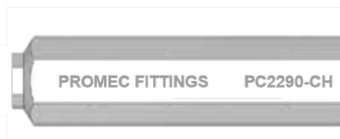

Misura tappo - Plug size	Codice Chiave Tool Code
6	PC2290-06-CH
8	PC2290-08-CH
10, 11, 12	PC2290-10-CH
14	PC2290-14-CH
15, 16	PC2290-15-CH
20	PC2290-20-CH
25	PC2290-25-CH

PC2290-TX TORX PER PC2290-CH
TORX FOR PC2290-CH



Misura tappo - Plug size	Codice Torx Torx Code
6	PC2290-TX06
8	PC2290-TX10
10, 11, 12	PC2290-TX10
14, 15, 16, 20, 25	PC2290-TX27